

Operating and installation instructions

Combined fridge-freezer with BioFresh compartment

GB

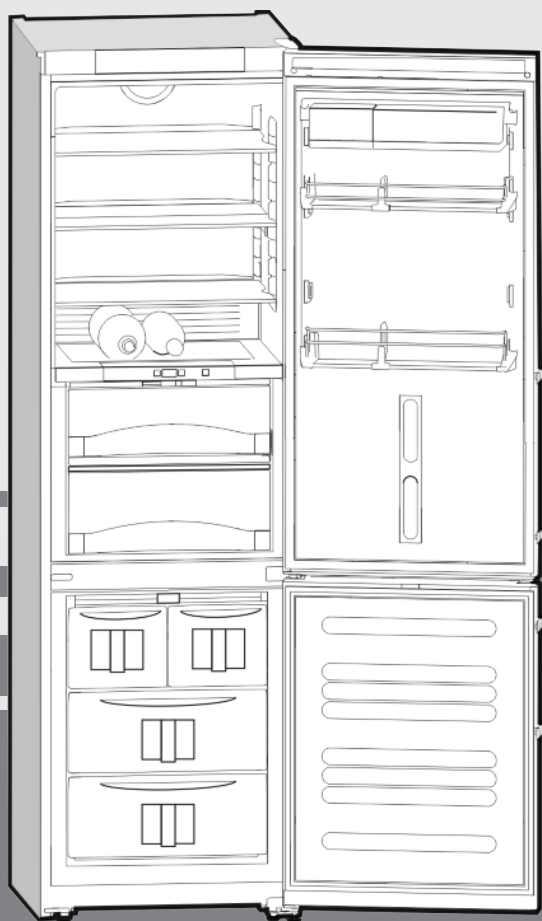

190710 **7084412 - 02**

CBNes ... 7

LIEBHERR

Appliance at a glance

Contents

1	Appliance at a glance	2
1.1	Description of appliance and equipment.....	2
1.2	Range of appliance use.....	2
1.3	Conformity.....	3
1.4	External dimensions of the appliance.....	3
1.5	Saving energy.....	3
1.6	HomeDialog.....	3
2	General safety information	3
3	Controls and displays	4
3.1	Menu structure.....	4
3.2	Operating the display.....	5
3.3	Temperature display.....	5
4	Putting into operation	5
4.1	Changing over the door hinges.....	5
4.2	Water connection.....	10
4.3	Insertion into a row of kitchen units.....	11
4.4	Transporting the appliance.....	11
4.5	Installing the appliance.....	12
4.6	Disposing of packaging.....	12
4.7	Connecting the appliance.....	12
4.8	Switching on the appliance.....	13
5	Control	13
5.1	Setting the language of the display.....	13
5.2	Brightness of the temperature display.....	13
5.3	Contrast of the temperature display.....	13
5.4	Storage time readout.....	13
5.5	Child proofing.....	14
5.6	Door alarm.....	14
5.7	Temperature alarm.....	14
5.8	Refrigerator compartment.....	14
5.9	BioFresh compartment.....	16
5.10	Freezer compartment.....	18
6	Maintenance	20
6.1	Defrosting with NoFrost.....	20
6.2	Cleaning the appliance.....	20
6.3	Cleaning the IceMaker.....	20
6.4	Changing the interior light with bulb.....	20
6.5	Customer service.....	21
7	Malfunction	21
8	Decommissioning	22
8.1	Switching off the appliance.....	22
8.2	Taking the appliance out of service.....	22
9	Disposing of the appliance	23

The manufacturer works constantly on the further development of all the types and models. Therefore please understand that we have to reserve the right to make design, equipment and technical modifications.

To get to know all the benefits of your new appliance, please read the information contained in these instructions carefully.

The instructions apply to several models. Differences may occur. Text relating only to specific appliances is marked with an asterisk (*).

Instructions for action are marked with a ►, the results of action are marked with a ▷.

1 Appliance at a glance

1.1 Description of appliance and equipment

Note

- Place food inside the appliance as shown in the diagram. This allows the appliance to save energy during operation.
- Shelves, drawers and baskets are arranged for optimum energy efficiency on delivery.

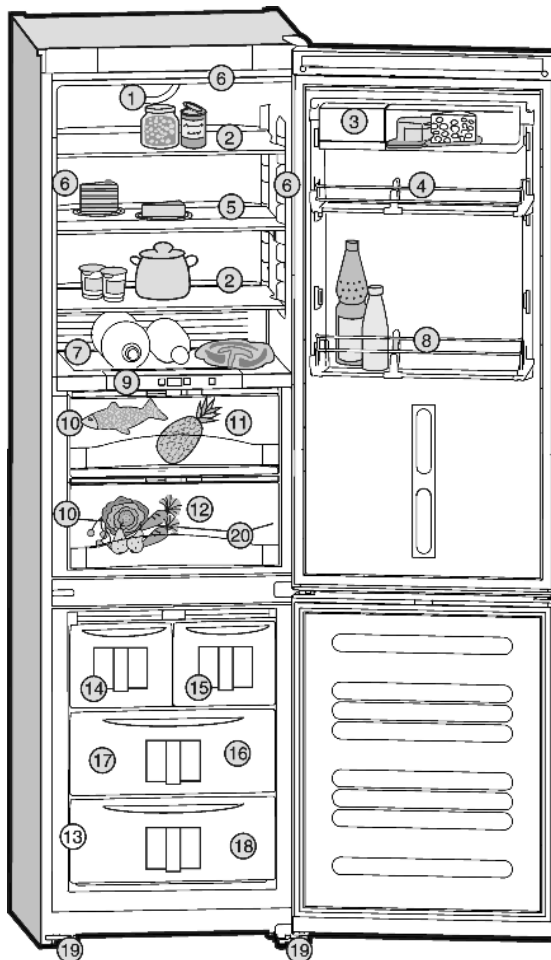

Fig. 1

- | | |
|---|---|
| (1) Fan | (11) BioFresh, HydroSafe/
DrySafe, BioFreshPlus* |
| (2) Glass shelf, relocatable | (12) BioFresh, HydroSafe/
DrySafe |
| (3) Box shelves, removable | (13) Type plate |
| (4) Rack for tinned food,
relocatable | (14) IceMaker |
| (5) Sectioned glass shelf,
relocatable | (15) Freezer compartment,
small |
| (6) Interior light* | (16) VarioSpace |
| (7) Separating plate with
bottle shelf | (17) Cold storage accumulators |
| (8) Bottle rack, relocatable | (18) Freezer compartment,
large |
| (9) Control panel for
BioFresh Plus* | (19) Adjustable feet |
| (10) BioFresh lighting* | (20) Drain hole defrost water* |

1.2 Range of appliance use

The appliance is suited only for cooling food.

In the case of commercial food cooling, the pertinent statutory regulations have to be observed. The appliance is not suited for storing and cooling pharmaceuticals, blood plasma, laboratory

preparations or similar substances and products subject to the Medical Devices Directive 2007/47/EC. Any misuse of the appliance may result in damage to or spoilage of the stored goods. Furthermore, the appliance is unsuited for use in areas exposed to an explosion hazard.

The appliance is set to operate within specific ambient temperature limits according to its climate rating. The correct climate rating for your appliance is indicated on the type plate.

Note

► Compliance with the ambient temperatures indicated is required, otherwise the cooling performance is reduced.

Climate rating	for ambient temperatures of
SN	10 °C to 32 °C
N	16 °C to 32 °C
ST	16 °C to 38 °C
T	16 °C to 43 °C

1.3 Conformity

The refrigerant circuit has been tested for leaks. The appliance complies with current safety regulations and EC directives 2006/95/EC and 2004/108/EC.

1.4 External dimensions of the appliance

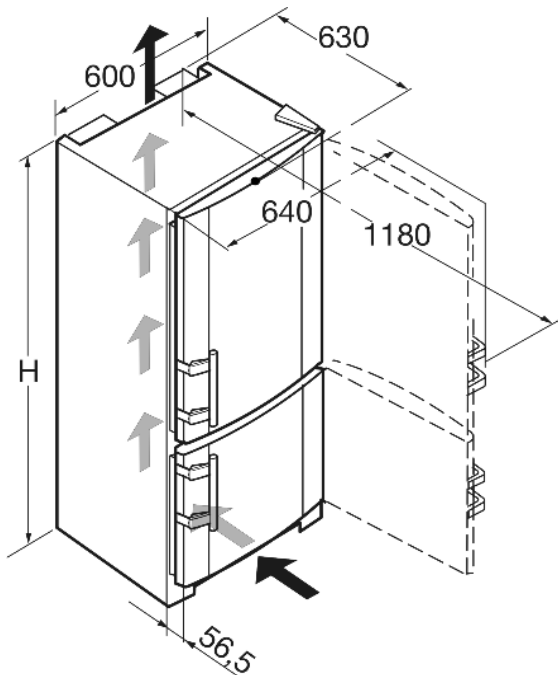

Fig. 2

Model	Height of appliance H (mm)
CBNes	2011

1.5 Saving energy

- Always ensure good ventilation. Do not cover ventilation openings or grille.
- Always keep fan louvres clear.
- Do not place appliance in areas of direct sunlight or next to a stove, heater or similar object.
- The energy consumption depends on the installation conditions, e.g. the ambient temperature (see 1.2).
- Keep the time the appliance is open to a minimum.
- Store food logically.

- Ensure that all food is well packed and covered for storage. This will prevent frost from forming.
- First cool warm food to room temperature before storing it.
- Defrost frozen food in the refrigerator.
- Use the vacation function for longer vacation periods (see 5.8.4).

Accumulated dust increases the energy consumption:

- Once a year, dust the refrigerating unit together with the metal grille of the heat exchanger at the back of the appliance.

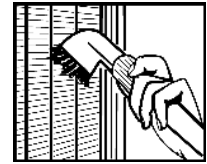

1.6 HomeDialog

Depending on model and options, the HomeDialog system can be used to network a number of Liebherr appliances (situated, for example, in the basement) with a main appliance (sited, for example, in the kitchen) and control them via the latter. You will find more information on the benefits, requirements and principle of operation on the internet at www.liebherr.com.



2 General safety information

Danger for the user:

- This appliance is not designed for persons (including children) with physical, sensory or mental impairment or persons not having sufficient experience and knowledge, unless they are instructed in the use of the appliance and are initially supervised by a person responsible for their safety. Keep children under supervision to ensure they do not play with the appliance.
- In case of a fault, pull out the mains plug (not by pulling the connecting cable) or switch off the fuse.
- Have any repairs to or intervention in the appliance, and any change of the mains power cable, carried out by the customer service only or by other specialised personnel trained for the purpose.
- When disconnecting the appliance from the supply, always take hold of the plug. Do not pull the cable.
- Install and connect the appliance only as instructed.
- Please keep these instructions in a safe place and pass them on to any subsequent owners.
- All repairs to and intervention in the IceMaker may be carried out only by service personnel or by other skilled personnel trained for the purpose.
- The manufacturer is not liable for damage caused by a faulty fixed water connection.
- Special-purpose lamps (incandescent lamps, LEDs, fluorescent tubes) in the appliance serve to illuminate the appliance interior and are not suited for room illumination.

Fire hazard:

- The refrigerant R 600a is environmentally friendly but flammable. Escaping refrigerant may ignite.
 - Do not damage the refrigerant circuit pipes.
 - Do not allow naked flames or ignition sources to enter the appliance.
 - Do not use any electrical appliances in the interior (e.g. steam cleaners, heaters, ice cream maker etc.).
 - If refrigerant escapes: eliminate naked flames or sources of ignition from the vicinity. Pull out the power plug. Ventilate the area well. Notify customer service.
- Do not store explosives or sprays using combustible propellants such as butane, propane, pentane, etc. in the appliance. Respective spray cans can be identified by reference to the contents printed on the can or by a flame symbol. Gases possibly escaping may ignite due to electrical components.

Controls and displays

- Do not place any burning candles, lamps or other items with naked flames on or in the appliance.
- Only store high-percentage alcohol in tightly sealed, upright containers. Alcohol possibly escaping may ignite due to electrical components.

Danger of tipping and falling:

- Do not misuse the plinth, drawers, doors etc. as a step or for support. This applies particularly to children.

Danger of food poisoning:

- Do not consume food which has been stored too long.



Danger of frostbite, numbness and pain:

- Avoid lasting skin contact with cold surfaces or refrigerated/frozen food or take protective steps, e.g. wear gloves. Do not consume ice cream, water ice or ice cubes immediately and do not consume them too cold.

Risk of crushing

- Do not reach into the soft stop mechanism. Fingers may be trapped when the door is closed.

Please observe the specific information in the other sections:

	WARNING	identifies a dangerous situation which, if not obviated, may result in death or severe bodily injury.
	CAUTION	identifies a dangerous situation which, if not obviated, may result in minor or medium bodily injury.
	NOTICE	identifies a dangerous situation which, if not obviated, may result in damage to property.
	Note	identifies useful information and tips.

	DANGER	identifies a situation involving direct danger which, if not obviated, may result in death or severe bodily injury.
---	--------	---

3 Controls and displays

3.1 Menu structure

MAIN MENU	REFRIGERATING	TEMPERATURE			
		BIOFRESHPLUS*			
		SUPERCool	ON / OFF		
			INFO		
		HOLIDAY	ON / OFF		
			INFO		
	ON / OFF	ON / OFF			
		INFO			
	FREEZING	TEMPERATUR			
		SUPERFROST	ON / OFF		
			INFO		
		ICEMAKER	TWISTCLEAN	START	
				INFO	
			WATER SUPPLY		
			ON / OFF		
		ON / OFF	ON / OFF		
		INFO			
	STORAGE TIMES	Product Groups	Product	STORAGE TIMES	
	ADDITIONAL FUNC-TIONS	CHILD PROOFING	ON / OFF		
			INFO		
		BIOFRESH	SETTING		
			INFO		
		BIOFRESHPLUS*	SETTING		
			INFO		
NET@HOME* / HOME-DIALOG SYSTEM*	Separate instructions				
TEMPERATURE	SETTING	Lighting setting			

			INFO
	CONTRAST		CONTRAST
			INFO
	LANGUAGE		Language selection

3.2 Operating the display

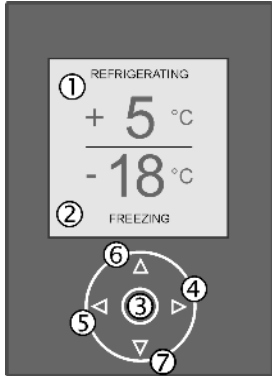

Fig. 3

- | | |
|--|-----------------|
| (1) Refrigerator compartment temperature display | (5) Left button |
| (2) Freezer compartment temperature display | (6) Up button |
| (3) OK button | (7) Down button |
| (4) Right button | |

You can operate all the functions of the appliance via the display:

- **To activate the main menu:** Press any button.
- **To move the cursor up:** Press Up button Fig. 3 (6).
- **To move the cursor down:** Press Down button Fig. 3 (7).
- **To move the cursor to the left:** Press left button Fig. 3 (5).
- **To move the cursor to the right:** Press right button Fig. 3 (4).
- Lengthy info text is on several pages in the display:
 - **To page forwards:** Press right button Fig. 3 (4).
 - **To page back:** Press left button Fig. 3 (5).
- **To confirm selection:** Press OK button Fig. 3 (3).
- **To quit menu:** Press left button Fig. 3 (5).

3.3 Temperature display

The following are displayed in normal operation:

- the warmest freezing temperature
- below the freezing temperature: the pre-set temperature in the freezer compartment
- the average cooling temperature
- above the cooling temperature: the pre-set temperature in the refrigerator compartment

The freezer compartment temperature display flashes:

- the temperature setting is being changed
- after switch-on the temperature is not yet cold enough
- the temperature has risen several degrees

Dashes flash in the display:

- the freezer temperature is above 0 °C.

The following displays indicate malfunction. Possible causes and corrective action (see Malfunction).

- F0 to F9

- FE
- POWER FAILURE
- CHECK WATER SUPPLY

4 Putting into operation

4.1 Changing over the door hinges

You can change over the door hinges if necessary.

Ensure that the following tools are to hand:

- Torx 25
- Torx 15
- Screwdriver
- Cordless screwdriver, if necessary
- Second person for fitting work, if needed

4.1.1 Detaching the upper soft stop mechanism

For appliances **with soft stop mechanism** start with this point.

For appliances **without soft stop mechanism** start with: (see 4.1.2).

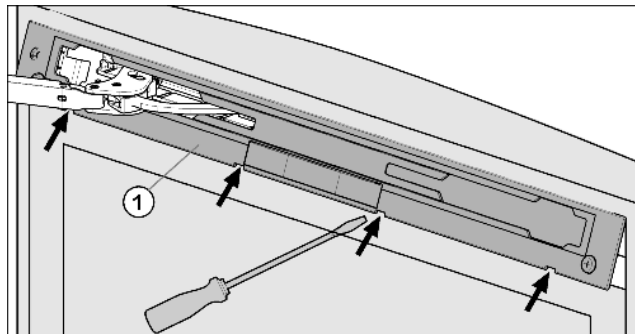

Fig. 4

- ▶ Open the upper door.

NOTICE

Risk of damage!

If the door seal is damaged, the door may fail to close properly and the cooling will be inadequate.

- ▶ Do not damage the door seal with the screwdriver!

- ▶ Disengage and remove the faceplate Fig. 4 (1) using a flat-blade screwdriver.

▷ The faceplate is attached over the soft stop bracket.

Putting into operation

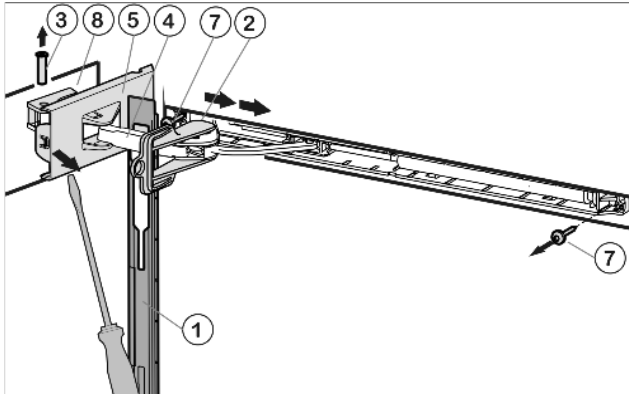

Fig. 5

- ▶ Slide the faceplate over the soft stop bracket Fig. 5 (4) in the direction of the appliance.
- ▶ Snap the safety lock Fig. 5 (2) into the oblong hole.
- ▷ The safety lock prevents the hinge from snap-closing.
- ▶ Using a screwdriver, detach the cover on the hinge side Fig. 5 (5) as far as the first detent.
- ▷ The pin becomes visible.
- ▶ Press the pin Fig. 5 (3) out from underneath.
- ▶ Press the soft stop bracket Fig. 5 (4) towards the door.
- ▶ Fully detach the cover on the hinge side Fig. 5 (5) and remove it.
- ▶ Remove the faceplate Fig. 5 (1).
- ▶ Using a screwdriver, detach the cover Fig. 6 (6) on the handle side and remove it outwards.

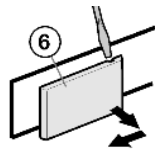

Fig. 6

- ▶ Unscrew the soft stop unit (2 Torx 15) Fig. 5 (7).
- ▶ Pull the soft stop unit out a little, push it in the direction of the handle side and swing it out.
- ▶ Set the soft stop unit aside.
- ▶ Unscrew the bearing element Fig. 7 (8), turn it 180° and transfer it to the opposite side. Possibly make preliminary holes with a bradawl or use a cordless screwdriver.

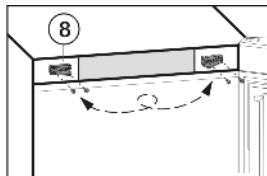

Fig. 7

4.1.2 Undo the cable connection on the housing.

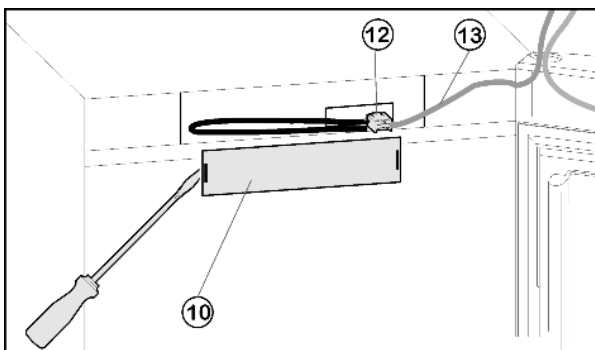

Fig. 8

- ▶ Open the upper door, if necessary.
- without soft stop mechanism.**

- ▶ To remove the cover on the handle side Fig. 9 (6): disengage on the right using a flat-blade screwdriver and slide it outwards.
- ▶ To remove the cover on the hinge side Fig. 9 (11): disengage on the left using a flat-blade screwdriver and slide it outwards.

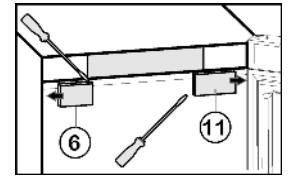

Fig. 9

all appliances:

- ▶ Remove the front panel Fig. 8 (10) using a flat-blade screwdriver.
- ▶ Remove contact and disconnect plug connector Fig. 8 (12).
- ▶ Detach grey cable Fig. 8 (13) from the guide.

4.1.3 Detaching the upper door

Note

- ▶ Remove any food from the door racks before removing the door, so that no food falls out.

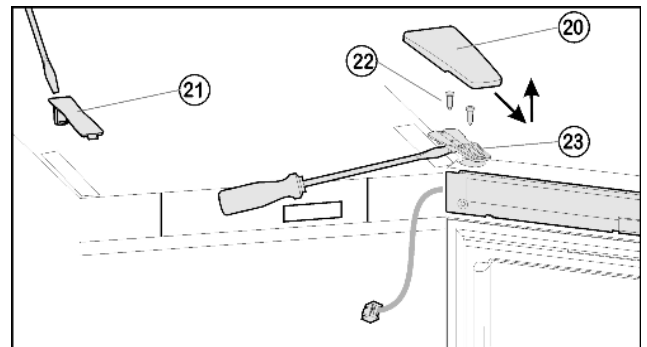

Fig. 10

- ▶ Pull off the cover Fig. 10 (20) forwards and upwards.
- ▶ Lift off the cover Fig. 10 (21).



CAUTION

Risk of injury if the door tips!

- ▶ Take good hold of the door.
- ▶ Set down the door carefully.

- ▶ Undo the screws Fig. 10 (22) all the way.
- ▶ Lift and remove the door complete with turn hinge Fig. 10 (23) and cable. For release, possibly use a flat-blade screwdriver to apply lever action under the turn hinge.
- ▶ Set the door aside.

4.1.4 Detaching the lower soft stop mechanism

For appliances with soft stop mechanism.

For appliances without soft stop mechanism continue with: (see 4.1.5) .

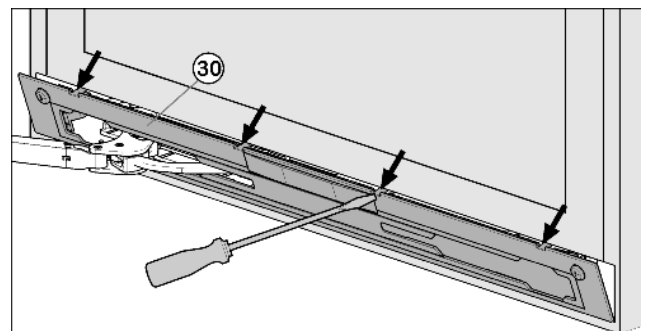

Fig. 11

- ▶ Open the lower door.

NOTICE

Risk of damage!

If the door seal is damaged, the door may fail to close properly and the cooling will be inadequate.

▶ Do not damage the door seal with the screwdriver!

- ▶ Disengage and remove the faceplate *Fig. 11 (30)* using a flat-blade screwdriver.
- ▷ The faceplate is attached over the soft stop bracket.

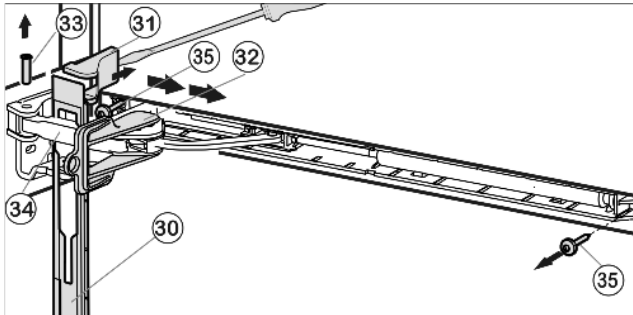

Fig. 12

- ▶ Slide the faceplate forwards over the soft stop bracket *Fig. 12 (34)* in the direction of the appliance.
- ▶ Snap the safety lock *Fig. 12 (32)* into the oblong hole
- ▷ The safety lock prevents the hinge from snap-closing.
- ▶ Using a screwdriver, lift off the cover *Fig. 12 (31)* from the outside and remove it in an outward direction.
- ▶ If necessary, tip the appliance backwards with the assistance of a second person.
- ▶ Press the pin *Fig. 12 (33)* out from underneath.
- ▶ Press the soft stop bracket *Fig. 12 (34)* towards the door.
- ▶ Remove the faceplate *Fig. 12 (30)*.
- ▶ Unscrew the soft stop unit (2 Torx 15) *Fig. 12 (35)*.
- ▶ Pull the soft stop unit out a little, push it in the direction of the handle side and swing it out.
- ▶ Set the soft stop unit aside.

4.1.5 Detaching the lower door

- ▶ Close the lower door.

without soft stop mechanism.

- ▶ Draw the middle bearing pin *Fig. 13 (41)* out of the turn hinge and lower door.

with soft stop mechanism.

- ▶ Draw the middle bearing pin *Fig. 13 (41)* together with the washer *Fig. 13 (44)* out of the turn hinge and lower door.

all appliances:

- ▶ Remove the plastic cap *Fig. 13 (40)*.



CAUTION

Risk of injury if the door tips!

- ▶ Take good hold of the door.
- ▶ Set down the door carefully.

- ▶ Open the lower door.
- ▶ Detach the middle turn hinge *Fig. 13 (42)*.
- ▶ Lift off the lower door and set it aside.

4.1.6 Transferring the middle bearing elements

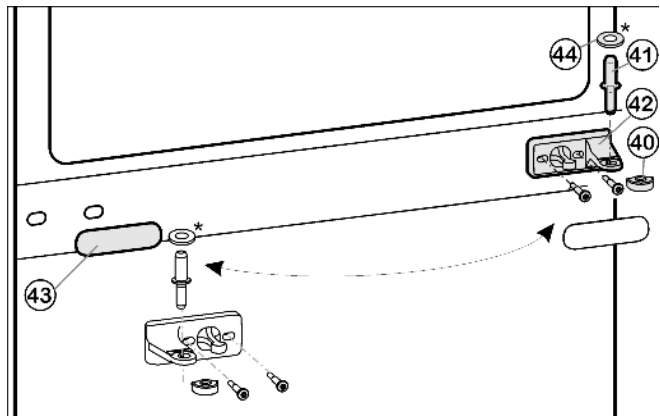

Fig. 13

- ▶ Carefully detach the cover panel *Fig. 13 (43)*.
- ▶ Turn the middle turn hinge *Fig. 13 (42)* through 180° and screw it firmly into place on the new hinge side (**with 4 Nm**).
- ▶ Turn the cover panel *Fig. 13 (43)* through 180° and snap it into place again on the new handle side.

4.1.7 Transferring lower bearing parts for appliances with soft stop mechanism

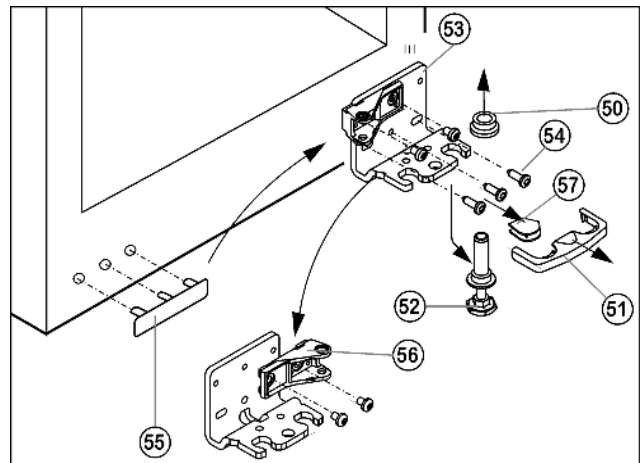

Fig. 14

- ▶ Draw the safety lock *Fig. 14 (51)* forwards for removal.
- ▶ Remove the cover *Fig. 14 (57)*.*
- ▶ Fully retract the adjustable-height foot *Fig. 14 (52)*.
- ▶ If necessary, tip the appliance back a little with the assistance of a second person for removal of the bearing pin.
- ▶ Pull out the bearing pin *Fig. 14 (52)* downwards and forwards. In so doing, pay attention to the hinge bush *Fig. 14 (50)*.
- ▶ Unscrew the turn hinge *Fig. 14 (53)* (3 Torx 25) *Fig. 14 (54)*.
- ▶ Carefully lift off and transfer the cover on the handle side *Fig. 14 (55)*.
- ▶ Screw the turn hinge *Fig. 14 (53)* firmly into place on the new hinge side, possibly using a cordless screwdriver (**with 4 Nm**).
- ▶ Unscrew the bearing part, *Fig. 14 (56)*, turn it 180° and screw it down again.

Putting into operation

- ▶ Tip the appliance back a little again and re-insert the bearing pin *Fig. 15 (52)*. The notch has to point forwards.
- ▶ Place the cover *Fig. 14 (57)* on the opposite side.*

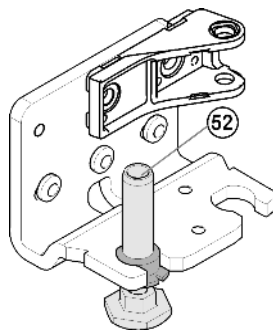
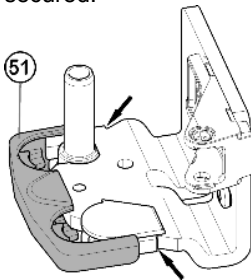

Fig. 15

CAUTION

Risk of injury if the door tips!

- ▶ The safety lock (51) has to engage with the turn hinge at the side so that the bearing pin and therefore the door are secured.



- ▶ Snap the safety lock (51) onto the turn hinge again.
- ▶ Put on the hinge bush *Fig. 14 (50)*.

4.1.8 Transferring lower bearing parts for appliances without soft stop mechanism

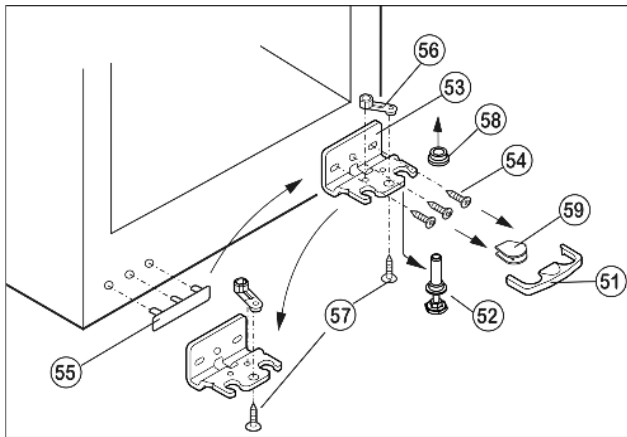

Fig. 16

- ▶ Draw the safety lock *Fig. 16 (51)* forwards for removal.
- ▶ Remove the cover *Fig. 16 (59)*.*
- ▶ Fully retract the adjustable-height foot *Fig. 16 (52)*.
- ▶ If necessary, tip the appliance back a little with the assistance of a second person for removal of the bearing pin.
- ▶ Pull out the bearing pin *Fig. 16 (52)* downwards and forwards. In so doing, pay attention to the hinge bush *Fig. 16 (58)*.
- ▶ Unscrew the turn hinge *Fig. 16 (53)*(3 x Torx 25) *Fig. 16 (54)*.
- ▶ Unscrew the bearing part *Fig. 16 (56)*(1 Torx 25) *Fig. 16 (57)*, transfer it to the opposite hole in the turn hinge and screw it down again.
- ▶ Carefully lift off and transfer the cover *Fig. 16 (55)* on the handle side.
- ▶ Screw the turn hinge *Fig. 16 (53)* firmly into place on the new hinge side, possibly using a cordless screwdriver (with 4 Nm).

- ▶ Tip the appliance back a little again and re-insert the bearing pin *Fig. 17 (52)*. The notch has to point forwards.
- ▶ Place the cover *Fig. 16 (59)* on the opposite side.*

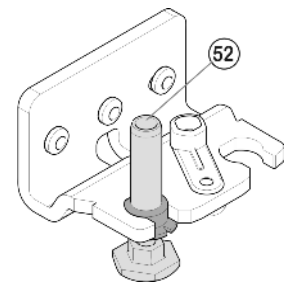
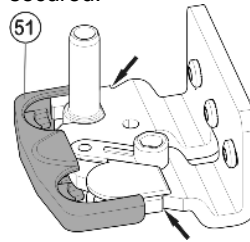

Fig. 17

CAUTION

Risk of injury if the door tips!

- ▶ The safety lock (51) has to engage with the turn hinge at the side so that the bearing pin and therefore the door are secured.



- ▶ Snap the safety lock (51) onto the turn hinge again.
- ▶ Put on the hinge bush *Fig. 16 (58)*.

4.1.9 Transferring the handles

without soft stop mechanism.

- ▶ Disengage the spring clip *Fig. 18 (71)* from the upper door and transfer it to the new hinge side.

all appliances:

- ▶ Lift the stopper *Fig. 18 (70)* out of the lower door bearing bush and transfer it.

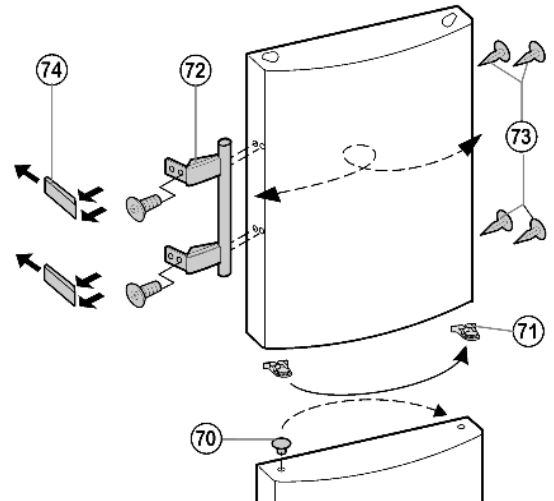

Fig. 18

- ▶ Detach the door handles *Fig. 18 (72)*, stoppers *Fig. 18 (73)* and pressure plates *Fig. 18 (74)* and transfer to the opposite side.
- ▶ When fitting the pressure plates at the opposite side, pay attention that they engage properly.

4.1.10 Fitting the lower door

- ▶ Place the door from above onto the bearing pin *Fig. 14 (52)*.
- ▶ Close the door.
- ▶ Place the plastic cap *Fig. 13 (40)* back onto the middle turn hinge *Fig. 13 (42)*.

- ▶ Insert middle bearing pin *Fig. 13 (41)* through middle turn hinge *Fig. 13 (42)* into the lower door.

with soft stop mechanism.

- ▶ Attach the washer *Fig. 13 (44)* to the middle bearing pin *Fig. 13 (41)*.

4.1.11 Fitting the lower soft stop mechanism

For appliances **with soft stop mechanism**.

For appliances **without soft stop mechanism** continue with: (see 4.1.12) .

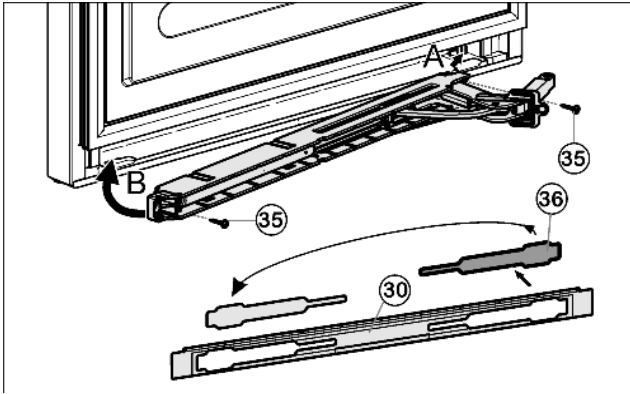

Fig. 19

- ▶ Remove the cover *Fig. 19 (36)* from the faceplate *Fig. 19 (30)* and re-insert it at the other side.
- ▶ Engage the soft stop unit with the joint on the hinge side (A) and swivel into place (B).
- ▷ The screw holes at the left and right have to register.
- ▶ Screw down the soft stop unit (2 Torx 15) *Fig. 19 (35)*.

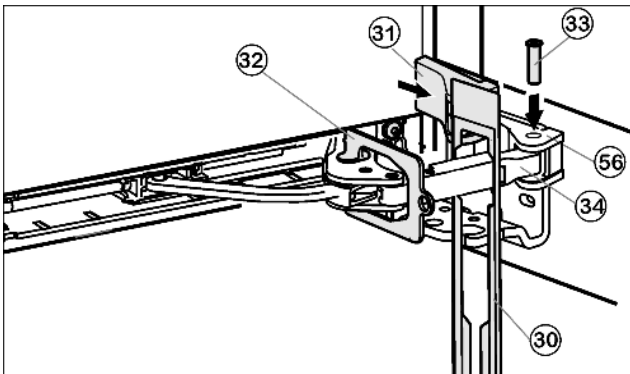

Fig. 20

- ▶ Attach the faceplate *Fig. 20 (30)* to the soft stop bracket so that the catches face forwards and the front faces the appliance.
- ▶ Draw the soft stop bracket *Fig. 20 (34)* towards the bearing part *Fig. 20 (56)* and insert the pin *Fig. 20 (33)* from above so that the square sits in the recess.
- ▶ Attach and engage the cover *Fig. 20 (31)*.
- ▷ Pay attention that the cover fits properly so that the door closes properly and the pin is secured.
- ▶ Twist the safety lock *Fig. 20 (32)* for removal.
- ▶ Snap the faceplate *Fig. 20 (30)* onto the door.
- ▶ Close the lower door.

4.1.12 Transferring the cable connection (upper door)

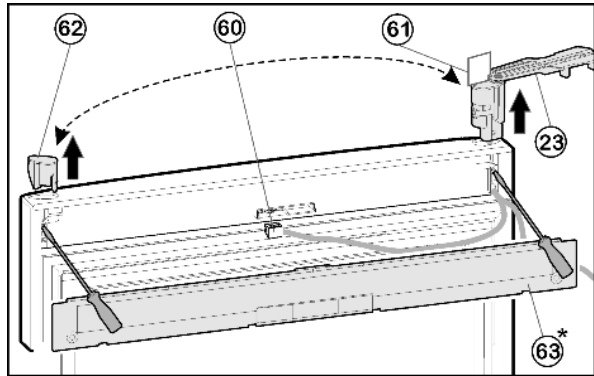

Fig. 21

- ▶ Using a screwdriver, disengage the cover *Fig. 21 (63)* on the door.
- ▶ Disconnect the plug connector *Fig. 21 (60)*.
- ▶ At the upper door, rotate the turn hinge *Fig. 21 (23)* in an outward direction, parallel to the door edge.

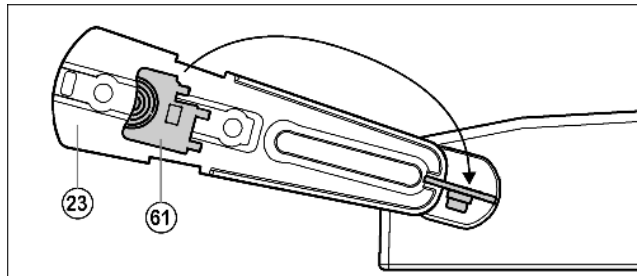

Fig. 22

NOTICE

Cables may be twisted and damaged as a result!

- ▶ Use the template.

- ▶ Detach the supplied template *Fig. 22 (61)* from the turn hinge and use it to prevent the turn hinge *Fig. 22 (23)* and bush from turning.
- ▶ Using a screwdriver, push out the turn hinge *Fig. 21 (23)* from underneath and remove it from the door complete with cable.
- ▶ Using a screwdriver, push out the stopper *Fig. 21 (62)* from underneath and transfer it to the opposite side.

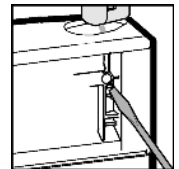

- ▶ Feed in the cable of the turn hinge *Fig. 21 (23)* at the opposite side and insert turn hinge.
- ▶ Remove the template *Fig. 21 (61)* and fasten it in the turn hinge.
- ▶ Plug in the plug *Fig. 21 (60)*.
- ▶ Place the cable in the guide.

without soft stop mechanism.

- ▶ Engage cover *Fig. 21 (63)* on the door.

4.1.13 Fitting the upper door

- ▶ Place the upper door on the middle bearing pin *Fig. 13 (41)*, close the door and attach the upper turn hinge *Fig. 10 (23)* so that it engages with the upper side of the appliance.
- ▶ Screw the turn hinge *Fig. 10 (23)* firmly into place (**with 4 Nm**). Possibly make preliminary holes with a bradawl or use a cordless screwdriver.
- ▶ Snap on the cover *Fig. 10 (20)* and cover *Fig. 10 (21)*.
- ▶ Re-connect the plug connector *Fig. 8 (12)*.
- ▶ Place the cable in the guide.
- ▶ Re-fit the cover *Fig. 8 (10)*.

without soft stop mechanism.

Putting into operation

- ▶ Turn the cover *Fig. 9 (6)* 180°, attach and engage it on the handle side.
- ▶ Turn the cover *Fig. 9 (11)* 180°, attach and engage it on the hinge side.

with soft stop mechanism.

- ▶ Leave the door open.

4.1.14 Fitting the upper soft stop mechanism

For appliances **with soft stop mechanism**.

For appliances **without soft stop mechanism** continue with: (see 4.1.15) .

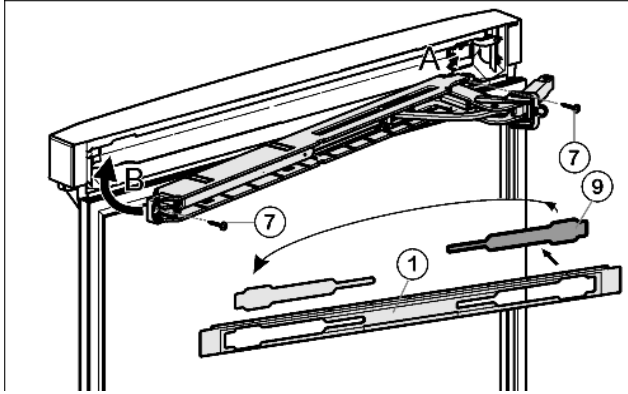

Fig. 23

- ▶ Remove the cover *Fig. 23 (9)* from the faceplate *Fig. 23 (1)* and re-insert it at the other side.
- ▶ Engage the upper soft stop unit with the joint on the hinge side (A) and swivel into place (B).
- ▷ The screw holes at the left and right have to register.
- ▶ Screw down the soft stop unit. (2 Torx 15) *Fig. 23 (7)*

Note

- ▶ Keep to the correct order. First attach the panel over the soft stop bracket, then the cover.

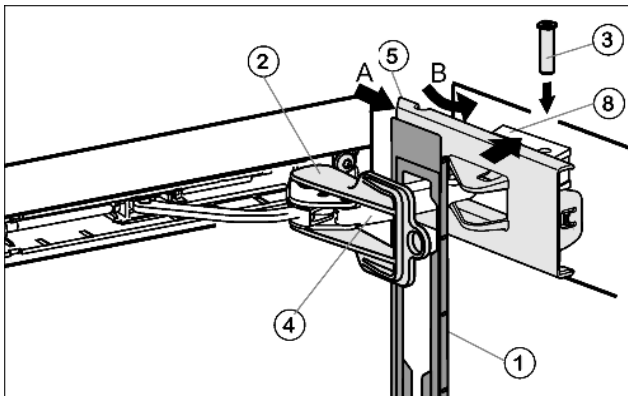

Fig. 24

- ▶ Attach the faceplate *Fig. 24 (1)* to the soft stop bracket *Fig. 24 (4)* so that the catches face inwards and the front faces the appliance.
- ▶ Slide on the cover *Fig. 24 (5)* from the outside (A) and swivel it over the bearing part *Fig. 24 (8)* (B).
- ▶ Attach the cover *Fig. 24 (5)* and engage it as far as the first detent.
- ▷ The openings for the pin are on top of one another after the soft stop bracket has been positioned.
- ▶ Draw the soft stop bracket *Fig. 24 (4)* towards the bearing part *Fig. 24 (8)* and insert the pin *Fig. 24 (4)* from above so that the square sits in the recess.
- ▶ Now completely snap the cover *Fig. 24 (5)* onto the bearing part *Fig. 24 (8)*.
- ▷ Pay attention that the cover fits properly so that the door closes properly and the pin is secured.
- ▶ Twist the safety lock *Fig. 24 (2)* for removal.
- ▶ Snap the faceplate *Fig. 24 (1)* onto the door.

- ▶ Turn the cover *Fig. 6 (6)* 180°, attach and engage it on the handle side.

4.1.15 Aligning the doors

- ▶ If necessary, align the door to the appliance housing by way of the two oblong holes in the lower turn hinge *Fig. 16 (53)* and middle turn hinge *Fig. 13 (42)*. To do so, unscrew the middle screw in the lower turn hinge *Fig. 16 (53)*.



WARNING

Risk of injury due to the door dropping out!
If the bearing parts are not screwed into place firmly enough, the door may drop out. This may lead to severe injuries. What is more, the door may not close and therefore the appliance may fail to cool properly.

- ▶ Screw the turn hinges firmly into place with 4 Nm.
- ▶ Check all of the screws and retighten if necessary.

4.2 Water connection



WARNING

Danger of electric shock!

- ▶ Disconnect the appliance by unplugging it before you connect it to the water line.
- ▶ Shut off the water supply before you connect the water feed lines of the IceMaker.
- ▶ The connection to the drinking water system may be carried out only by a qualified gas fitter and plumber.



WARNING

Risk of poisoning!

- ▶ The water quality has to comply with the drinking water ordinance of the respective country (e.g. 98/8
- ▶ The IceMaker serves exclusively for making ice cubes in household quantities and has to be operated with water suitable for the purpose.

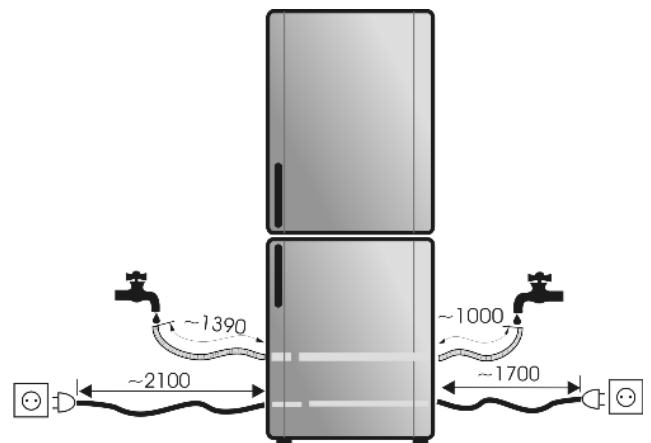
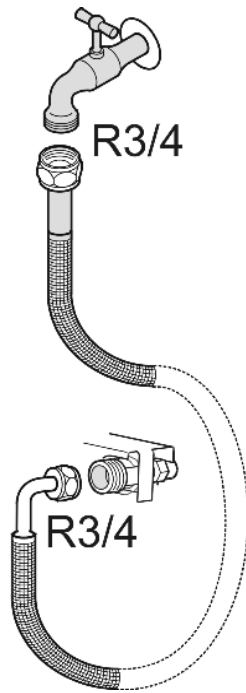

Fig. 25

- The water pressure has to be between 0.15 MPa and 0.6 MPa (1.5 bar - 6 bar).
- The water supply to the appliance must be via a cold water pipe which withstands the operating pressure and complies with the hygiene regulations. Use the accompanying stainless steel hose (1.5 m). Do not reuse old hoses. A 3 m hose is available from the customer service department and has to be fitted by an expert. In the hose connecting piece is a sieve with seal.
- Between the hose and the domestic water connection there has to be a stopcock to interrupt the water supply in case of need.
- All the fixtures and fittings used for water supply have to comply with the applicable regulations of the respective country.
- Do not damage or kink the water inlet pipe when installing the appliance.



- ▶ Connect the straight part of the accompanying stainless steel hose to the stopcock.

The solenoid valve is at the bottom back of the appliance. It has a metric R3/4 connecting thread.

- ▶ Connect the angled part of the stainless steel hose to the solenoid valve.
- ▶ Open the stopcock of the water supply and check that the entire water system is leakproof. Before initial use:
- ▶ Have the water pipe bled of air by the proper expert.



4.3 Insertion into a row of kitchen units

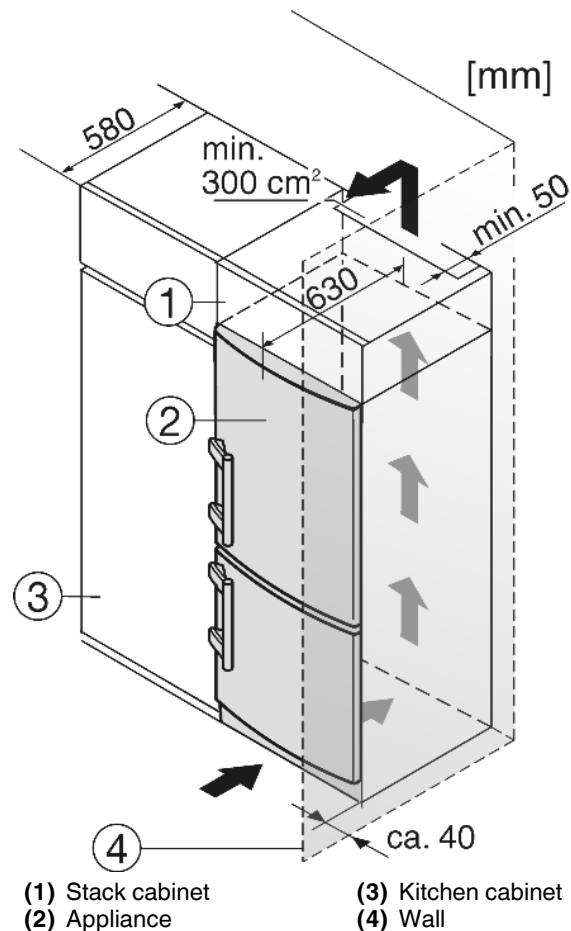

Fig. 26

- (1) Stack cabinet
- (2) Appliance
- (3) Kitchen cabinet
- (4) Wall

The appliance can be inserted into a row of kitchen units. To match the appliance Fig. 26 (2) to the height of the row of units, a suitable stack cabinet Fig. 26 (1) can be fitted above the appliance.

When inserting the appliance into a row of kitchen units (max. depth 580 mm), the appliance can be installed directly next to the kitchen unit Fig. 26 (3). The appliance door projects relative to the front of the kitchen unit by 34 mm at the side and by 50 mm in the middle of the appliance. It can be opened and closed perfectly as a result.

Important for the ventilation:

- At the back of the stack cabinet there has to be a ventilation duct of at least 50 mm depth throughout the width of the stack cabinet.
- The ventilation space under the ceiling has to be at least 300 cm².
- The larger the ventilation space, the more energy-saving the appliance is in operation.

If the appliance is installed with the hinges next to a wall Fig. 26 (4), the distance between appliance and wall has to be at least 40 mm. This corresponds to the projection of the handle when the door is open.

4.4 Transporting the appliance



CAUTION

Risk of injury and danger of damage as a result of incorrect transport!

- ▶ Transport the appliance in a packed condition.
- ▶ Transport the appliance upright.
- ▶ Do not transport the appliance without assistance.

Putting into operation

4.5 Installing the appliance

In the event that the appliance is damaged, contact the supplier immediately before connecting to the mains.

The floor at the site must be flat and level.

Do not install the appliance in a location where it is exposed to direct radiation of the sun, next to a cooker, heater and similar.

Always install the appliance with the back directly against the wall.

Do not install the appliance without assistance.

Standard EN 378 specifies that the room in which you install your appliance must have a volume of 1 m² per 8 g of R 600a refrigerant used in the appliance. If the room in which the appliance is installed is too small, a flammable gas-air mixture may form in the event of a leakage in the refrigeration circuit. The quantity of refrigerant used in your appliance is indicated on the type plate on the inside of the appliance.



WARNING

Fire hazard due to dampness!

If live parts or the mains lead become damp this may cause short circuits.

- ▶ The appliance is designed for use in enclosed areas. Do not operate the appliance outdoors or in areas where it is exposed to splash water or damp conditions.



WARNING

Fire hazard due to refrigerant!

The refrigerant R 600a is environmentally friendly but flammable. Escaping refrigerant may ignite.

- ▶ Do not damage the piping of the refrigeration circuit.



WARNING

Fire hazard and danger of damage!

- ▶ Do not place appliances emitting heat e.g. microwaves, toasters etc. on the appliance!



WARNING

Blocked ventilation openings pose a risk of fire and damage!

- ▶ Always keep the ventilation openings clear. Always ensure that the appliance is properly ventilated!

- ▶ Detach the connecting cable from the rear of the appliance, removing the cable holder at the same time because otherwise there will be vibratory noise!

- ▶ Remove the protective film from the outside of the appliance.

NOTICE

The stainless steel doors are provided with a high-quality surface coating and must not be treated using the accompanying care product.



Otherwise the surface coating will be affected.

- ▶ Wipe the coated **door surfaces** using a soft, clean cloth only.
- ▶ Apply a stainless steel cleaner only to the **stainless steel side walls** evenly, wiping with the grain. Subsequent cleaning becomes easier as a result.
- ▶ Wipe **side walls with a paint finish** using a soft, clean cloth only.

- ▶ Remove all transit supports.
- ▶ Dispose of packaging material (see 4.6) .

NOTICE

Risk of damage due to condensate!

- ▶ Do not install the appliance directly alongside a further refrigerator/freezer.

- ▶ Align the appliance so that it stands firmly and on a level by applying the accompanying spanner to the adjustable-height feet (A) and using a spirit level.

- ▶ Then support the door: Extend the adjustable foot at the turn hinge (B) until it rests on the floor and then make a further 90° turn.

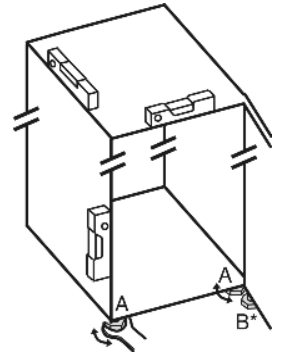

If the appliance is installed in a very damp environment, condensate may form on the outside of the appliance.

- ▶ Always see to good ventilation at the installation site.

4.6 Disposing of packaging



WARNING

Danger of suffocation due to packing material and plastic film!

- ▶ Do not allow children to play with packing material.

The packaging is made of recyclable materials:

- corrugated board/cardboard
- expanded polystyrene parts
- polythene bags and sheets
- polypropylene straps

- ▶ Take the packaging material to an official collecting point.



4.7 Connecting the appliance

NOTICE

Risk of damage to the electronic control system!

- ▶ Do not use stand-alone inverters (conversion of d.c. to a.c./ three-phase) or energy saving plugs.



WARNING

Fire and overheating hazard!

- ▶ Do not use extension cables or multiple socket outlets.

Current type (alternating current) and voltage at the installation site must be in conformity with the data on the type plate situated inside the appliance, on the left.

Connect the appliance only with a properly installed socket outlet with earthing contact. The socket outlet must be fused with 10 A or higher.



It must be easily accessible so that the appliance can be quickly disconnected from the supply in an emergency.

- ▶ Clean the appliance (see 6.2) .
- ▶ Plug in the power plug.

When the language selection is indicated in the display:

- ▶ To select the language: Move the cursor down using the Down button *Fig. 3 (7)*, move the cursor up using the Up button *Fig. 3 (6)*.
- ▶ Confirm with the OK button *Fig. 3 (3)*.



4.8 Switching on the appliance

4.8.1 Switching on the refrigerator compartment

The appliance is supplied in the switched-off state.

If you want to switch on the entire appliance, you only have to switch on the refrigerator compartment. The freezer compartment is automatically switched on as well.

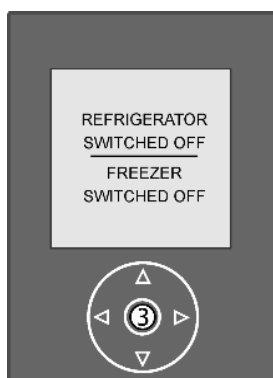

- ▶ Activate the MAIN MENU.
- ▶ Activate the REFRIGERATOR menu
- ▶ Set the cursor to ON/OFF.
- ▶ Press OK button *Fig. 3 (3)*.
- ▷ The ON/OFF menu is displayed.
- ▶ Press OK button *Fig. 3 (3)*.
- ▷ The current cooling temperature is displayed in the temperature display refrigerator compartment *Fig. 3 (1)*. The preset temperature is indicated above.
- ▷ The temperature display freezer compartment flashes until the temperature is cold enough. If the temperature is above 0 °C, dashes flash. If it is below, the current temperature flashes. The preset temperature is indicated underneath.

5 Control

5.1 Setting the language of the display

- ▶ Activate the main menu.
- ▶ Activate the ADDITIONAL FUNCTIONS -> CONFIGURATION -> LANGUAGE menu items one after the other.
- ▷ The language selection is indicated in the display.
- ▶ Set the cursor to the language wanted.
- ▶ Press OK button *Fig. 3 (3)*.
- ▷ All the menu texts will be displayed in the language now selected.



5.2 Brightness of the temperature display

You can adjust the brightness of the temperature display to the light conditions of the room in which the appliance is installed.

5.2.1 Adjusting the brightness

The brightness is adjustable between 0 (min. luminosity) and 5 (max. luminosity).

- ▶ Activate the main menu.
- ▶ Activate the ADDITIONAL FUNCTIONS -> CONFIGURATION -> LIGHTING menu items one after the other.
- ▷ The LIGHTING menu is displayed.

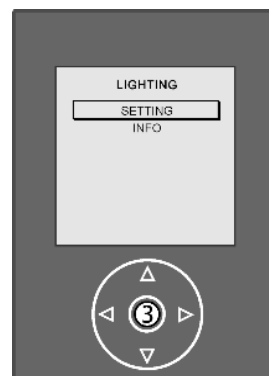

- ▶ Press OK button *Fig. 3 (3)*.
- ▶ For a brighter setting: Press Up button *Fig. 3 (6)*.
- ▶ For a darker setting: Press Down button *Fig. 3 (7)*.
- ▶ Press OK button *Fig. 3 (3)*.
- ▷ The new setting is accepted.

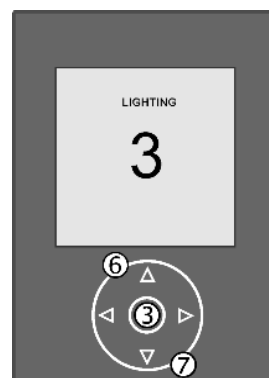

5.3 Contrast of the temperature display

You can adjust the contrast between lettering and background in the temperature display.

5.3.1 Adjusting the contrast

The contrast is adjustable between 1 (low contrast) and 10 (high contrast).

- ▶ Activate the MAIN MENU.
- ▶ Activate the ADDITIONAL FUNCTIONS -> CONFIGURATION -> CONTRAST menu items one after the other.
- ▶ For a higher contrast setting: Press Up button *Fig. 3 (6)*.
- ▶ For a lower contrast setting: Press Down button *Fig. 3 (7)*.
- ▶ Press OK button *Fig. 3 (3)*.
- ▷ The new setting is accepted.

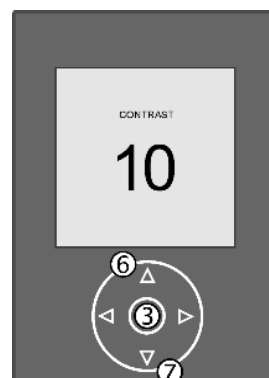

5.4 Storage time readout

- ▶ Activate the MAIN MENU.
- ▶ Activate the STORAGE TIME menu item.
- ▷ An info text about the storage time of food is displayed.
- ▶ Press OK button *Fig. 3 (3)*.

-or-

- ▶ Wait for 30 seconds.

- ▷ The STORAGE TIME menu is displayed again.

Control

- ▶ Activate one of the groups of food.
- ▷ An A to Z table appears in the display. The letters stand for the first letters of the food looked for.
- ▶ Set the cursor to the letter wanted.
- ▶ Press OK button *Fig. 3 (3)*.
- ▷ A list of food names appears in the display. The cursor is at the first food type beginning with the previously selected letter. If a letter is selected which does not exist as an initial letter in the list, the cursor is at the next letter.

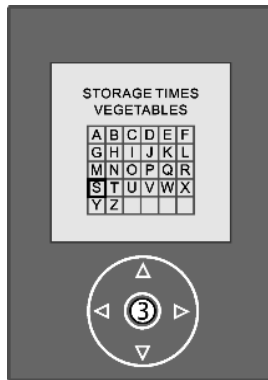

BioFresh:



BioFreshPlus:

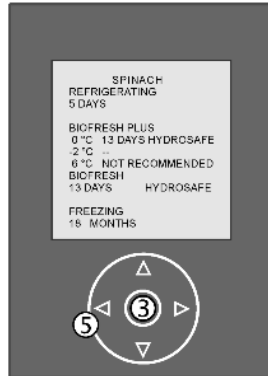

- ▶ Confirm the corresponding food type with the OK button *Fig. 3 (3)*.
- ▷ The recommended storage time is indicated in the display.
- ▷ The storage periods relate to the respective storage location. "--" signifies unsuited.
- ▶ To go back to the groups of food: Press left button *Fig. 3 (5)*.
- ▶ To go back to the temperature display: Press OK button *Fig. 3 (3)*.

5.5 Child proofing

The child-proofing function enables you to make sure that the appliance is not inadvertently switched off by playing children.

5.5.1 Activating the child lock

- ▶ Activate the MAIN MENU.
- ▶ Activate the ADDITIONAL FUNCTIONS -> CHILD LOCK -> INFO menu items one after the other.
- ▷ The info text in the display describes the purpose of the child lock.
- ▶ Press the left button *Fig. 3 (5)* until ON and INFO are indicated in the display.
- ▶ Activate ON.
- ▷ The child lock is switched on. The  appears.
- ▷ No settings can be made. If any button is pressed, an info text appears. The appliance settings can be changed after pressing the OK button for 3 seconds

5.5.2 Deactivating the child lock

- ▶ Activate the MAIN MENU.
- ▶ Activate the ADDITIONAL FUNCTIONS -> CHILD LOCK -> OFF menu items one after the other.
- ▷ The child lock is deactivated. The child lock symbol goes out.

5.6 Door alarm

For refrigerator/BioFresh compartment and freezer compartment

If the door is open longer than 60 s, the audible alarm sounds. The display indicates: PLEASE CLOSE DOOR.

The audible alarm is automatically silenced when the door is closed.

The temperature of the appliance compartment which triggered the alarm is indicated in the display.

5.6.1 Muting the door alarm

The audible alarm can be muted when the door is open. The sound switch-off function is active as long as the door is left open.

- ▶ Press OK button *Fig. 3 (3)*
- ▷ The door alarm is silenced.
- ▷ The temperature is indicated in the display. The display changes to the normal temperature display.

5.7 Temperature alarm

The audible alarm sounds if the freezer temperature is not cold enough.

The display reads: TEMPERATURE TOO HIGH.

The cause of the temperature being too high may be:

- warm fresh food was placed inside
- too much warm ambient air flowed in when rearranging and removing food
- power failure for some time
- the appliance is faulty

The audible alarm is automatically silenced when the temperature is sufficiently cold again.

If the alarm status persists: (see Malfunction).

Note

- Food may be spoiled if the temperature is not cold enough.
- ▶ Check the quality of the food. Do not consume spoiled food.

5.7.1 Muting the temperature alarm

The audible alarm can be muted. When the temperature is sufficiently cold again, the alarm function is active again.

- ▶ Press OK button *Fig. 3 (3)*.
- ▷ The audible alarm is silenced.
- ▷ The display changes back to temperature display.

5.8 Refrigerator compartment

The natural circulation of air in the refrigerator compartment results in zones differing in temperature. It is coldest directly above the plate separating off the BioFresh zone and at the rear wall. It is warmest at the top front of the compartment and in the door.

5.8.1 Food refrigeration

Note

- The energy consumption increases and the cooling performance decreases if the ventilation is inadequate.
- ▶ Always keep the air slits of the fan free.

- ▶ Place butter and preserves in the upper area and in the door (see Appliance at a glance).
- ▶ Use recyclable plastic, metal, aluminium and glass containers and cling film for wrapping.
- ▶ Use the front area of the refrigerator compartment floor only for briefly putting down cooled products, e.g. when rearranging and sorting. However do not leave cooled products there otherwise they may be pushed back or tipped over when the door is closed.
- ▶ Do not store food too close together to enable good air circulation.
- ▶ To safeguard bottles from tipping over: move the bottle holder.

At the base of the refrigerator compartment, the integrated bottle shelf or alternatively the glass shelf can be used:

- ▶ To use the bottle shelf: store the glass shelf compactly under the bottle shelf.
- ▶ Place the bottles with the base pointing backwards facing the rear wall.
- ▶ If the bottles project beyond the bottle shelf:
- ▶ set the lower door rack one position higher.

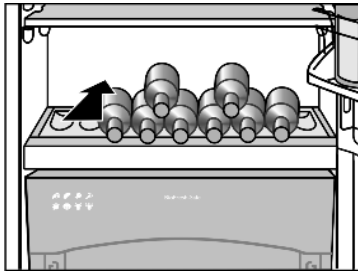

5.8.2 Adjusting the temperature

The temperature is adjustable from +9 °C to +3 °C / for appliances with BioFreshPlus +9 °C to +2 °C, the recommended temperature is +5 °C.

- ▶ Activate the MAIN MENU.
- ▶ Activate the REFRIGERATOR -> TEMPERATURE menu items one after the other.
- ▷ An info text on the recommended refrigerator temperature appears. Then the current temperature is displayed at the top and the temperature desired at the bottom.
- To alter the temperature in 1 °C steps: press the button briefly.
- To change the temperature continuously: hold down the button.
- ▶ To set a higher temperature: Press Up button *Fig. 3 (6)*.
- ▶ To set a lower temperature: Press Down button *Fig. 3 (7)*.
- ▶ To accept the setting: Press OK button *Fig. 3 (3)*.
- ▷ The refrigerator temperature slowly adjusts itself to the new value.
- ▶ To cancel the operation: Press left button *Fig. 3 (5)*.

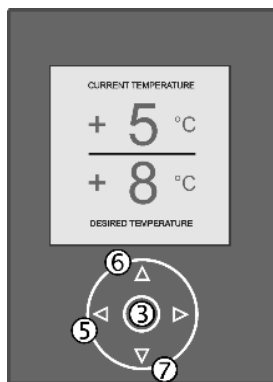

-or-

- ▶ Do not press any button for 10 seconds.

5.8.3 SuperCool

With SuperCool you switch to the highest cooling performance to reach lower cooling temperatures. Use SuperCool, to rapidly cool large amounts of food.

The SuperCool function uses slightly more energy.

Cooling with SuperCool

- ▶ Activate the MAIN MENU.
- ▶ Activate the REFRIGERATOR -> SUPERCOOL -> INFO menu items one after the other.
- ▷ The info text in the display describes the purpose for which SuperCool is used.
- ▶ Press the OK button *Fig. 3 (3)* until ON and INFO are indicated in the display.
- ▶ Select ON.
- ▶ Press OK button *Fig. 3 (3)*.
- ▷ SuperCool is activated.
- ▷ SuperCool is automatically deactivated after 6 to 12

To deactivate SuperCool ahead of time

- ▶ Activate the MAIN MENU.
- ▶ Activate the REFRIGERATOR -> SUPERCOOL -> OFF menu items one after the other.
- ▷ SuperCool is deactivated.

5.8.4 Holiday mode

The holiday mode saves energy and prevents odour from occurring when the door of the refrigerator compartment stays closed for a lengthy period.

The freezer compartment remains in operation in the holiday mode.

Activating the holiday mode

- ▶ Remove all the food.
- ▶ Activate the MAIN MENU.
- ▶ Activate the REFRIGERATOR -> HOLIDAY-> INFO menu items one after the other.
- ▷ The info text in the display describes the purpose for which holiday mode is used.
- ▶ Press the OK button *Fig. 3 (3)* until ON and INFO are indicated in the display.
- ▶ Set the cursor to ON.
- ▶ Press OK button *Fig. 3 (3)*.
- ▷ The holiday mode is activated. HOLIDAY is indicated in the display at the top instead of refrigerator compartment temperature.

Deactivating the holiday mode

- ▶ Activate the MAIN MENU.
- ▶ Activate the REFRIGERATOR -> HOLIDAY -> OFF menu items one after the other.
- ▷ The holiday mode is deactivated.

5.8.5 Relocating the shelves

The shelves have stops preventing them from being unintentionally pulled out.

- ▶ Lift the shelf and draw it out forwards.

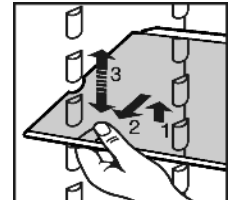

- ▶ Insert shelf with the raised edge pointing upwards at the back.
- ▷ The food does not freeze onto the rear wall.

5.8.6 Using the sectioned shelf

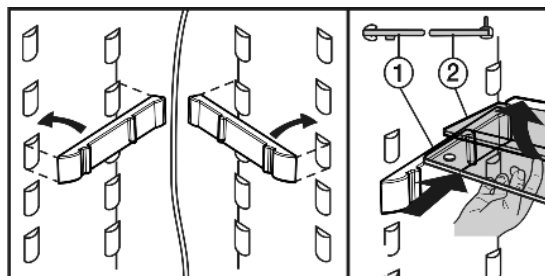
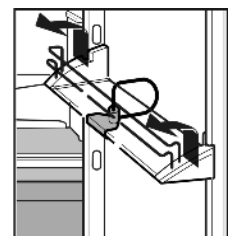

Fig. 27

- ▶ The glass shelf with stop face (2) has to be at the back.

5.8.7 Moving the storage rack

- ▶ Remove storage rack according to illustration.



The boxes can be removed and placed on the table as a single unit.

Only one box or both boxes can be used. If particularly tall bottles are to be stored, attach only the wide box above the bottle rack.

Three small boxes are available through the customer service as optional equipment instead of one wide and one small box.

Control

- ▶ Re-positioning the boxes: Lift them for removal and re-position them as required.

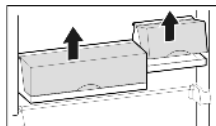

- ▶ To detach lid: Open 90° and raise to disengage.

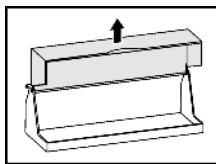

5.8.8 Removing the bottle holder

- ▶ Always take hold of the bottle holder on the plastic part.

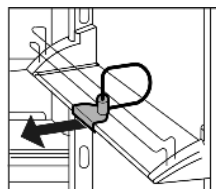

5.9 BioFresh compartment

The BioFresh compartment allows some types of fresh food to be stored up to three times longer than in conventional refrigerators, without compromising quality.

For food with an indicated best before date, the date specified on the packaging always applies.

5.9.1 HydroSafe

The HydroSafe at the moist setting is suited for storing unwrapped salad, vegetables and fruit with high inherent moisture. When the drawer is well filled, a dewy climate with up to 90% humidity is established. The humidity in the compartment depends on the moisture content of the food stored and on the opening frequency. You can set the humidity yourself.

5.9.2 DrySafe

The DrySafe is suitable for storing dry or wrapped food (e.g. dairy products, meat, fish, sausages). A relatively dry storage climate is established here.

5.9.3 BioFreshPlus compartment (adjustable)*

The adjustable BioFreshPlus compartment is suited for storing seafood, fruit/vegetables or tropical fruits, depending on setting.

5.9.4 Storing food

Note

- ▶ Vegetables sensitive to cold, such as cucumbers, aubergines, semi-ripe tomatoes, zucchinis and all tropical fruits sensitive to cold, do not belong in the BioFresh compartment.

- ▶ Store citrus and tropical fruits in the BioFreshPlus compartment at +6 °C.*

- ▶ To prevent food spoilage due to transfer of germs: Store unwrapped animal and vegetable products separate from one another in the drawers. This also applies to different sorts of meat.

If food has to be stored together due to lack of space:

- ▶ wrap the food.

5.9.5 Storage times*

Standard values for storage time at low humidity			
Butter	up to	90	days
Hard cheese	up to	110	days

Standard values for storage time at low humidity			
Milk	up to	12	days
Sausage, cold meat	up to	9	days
Poultry	up to	6	days
Pork	up to	7	days
Beef	up to	7	days
Game	up to	7	days

Note

- ▶ Please note that protein-rich food deteriorates faster, i.e. shellfish and crustaceans deteriorate faster than fish, fish faster than meat.

Standard values for storage time at high humidity			
Vegetables, salad			
Artichokes	up to	14	days
Celery	up to	28	days
Cauliflower	up to	21	days
Broccoli	up to	13	days
Chicory	up to	27	days
Lamb's lettuce	up to	19	days
Peas	up to	14	days
Kale	up to	14	days
Carrots	up to	80	days
Garlic	up to	160	days
Kohlrabi	up to	55	days
Lettuce	up to	13	days
Herbs	up to	13	days
Leek	up to	29	days
Mushrooms	up to	7	days
Radishes	up to	10	days
Brussels sprouts	up to	20	days
Asparagus	up to	18	days
Spinach	up to	13	days
Savoy cabbage	up to	20	days
Fruit			
Apricots	up to	13	days
Apples	up to	80	days
Pears	up to	55	days
Blackberries	up to	3	days
Dates	up to	180	days
Strawberries	up to	7	days
Figs	up to	7	days
Blueberries	up to	9	days
Raspberries	up to	3	days
Currants	up to	7	days
Sweet cherries	up to	14	days
Kiwis	up to	80	days

Standard values for storage time at high humidity			
Peaches	up to	13	days
Plums	up to	20	days
Cranberries	up to	60	days
Rhubarb	up to	13	days
Gooseberries	up to	13	days
Grapes	up to	29	days

Additional standard values for storage time in the BioFreshPlus compartment			
Seafood			
Crab	at -2 °C	up to	4 days
Mussels	at -2 °C	up to	6 days
Sushi	at -2 °C	up to	4 days
Tropical fruits			
Papaya	at 6 °C	up to	15 days
Prickly pear	at 0 °C	up to	20 days
Passion fruit	at 6 °C	up to	24 days
Lemons	at 6 °C	up to	45 days
Limes	at 6 °C	up to	55 days

5.9.6 Setting the temperature for BioFreshPlus on the control panel*

- ▶ The temperature for the BioFreshPlus compartment can be set separately on the control panel. (see Appliance at a glance)

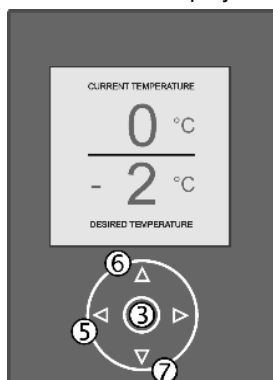

Fig. 28

- ▶ Setting for fish and seafood: Press -2 °C button.
- ▶ Setting as normal BioFresh compartment: Press 0 °C button.
- ▶ Setting for tropical fruits: Press 6 °C button.

5.9.7 Setting the temperature for BioFreshPlus on the display*

- ▶ As an alternative to control panel setting, the temperature in the BioFreshPlus compartment can be set on the display.
- ▶ Activate the MAIN MENU.
- ▶ Activate the COOLING -> BIOFRESHPLUS menu items one after the other.
- ▷ The current temperature appears at the top and the temperature wanted appears at the bottom of the display.
- ▶ To set the temperature higher: Press the Up button Fig. 3 (6).
- ▶ To set the temperature lower: Press the Down button Fig. 3 (7).
- ▶ To accept the setting: Press the OK button Fig. 3 (3).
- ▷ The BioFresh temperature slowly adjusts to the new value.
- ▶ To stop the operation: Press the Left button Fig. 3 (5).



- or-
- ▶ Do not press any button for 10 s.

5.9.8 Adjusting the temperature in the BioFresh compartment

The temperature in the BioFresh compartment and BioFresh-Plus* compartment is separately adjustable.

The B5/U5* default conforms with the IEC 62552 standard.

- ▶ Activate the ADDITIONAL FUNCTIONS menu.
- ▶ Activate BIOFRESH OR BIOFRESHPLUS*.
- ▶ Select INFO.
- ▶ Press OK button Fig. 3 (3).
- ▷ The info text in the display shows the BioFresh temperature setting range.
- ▶ Press the left button Fig. 3 (5) until SETTING and INFO are indicated in the display.

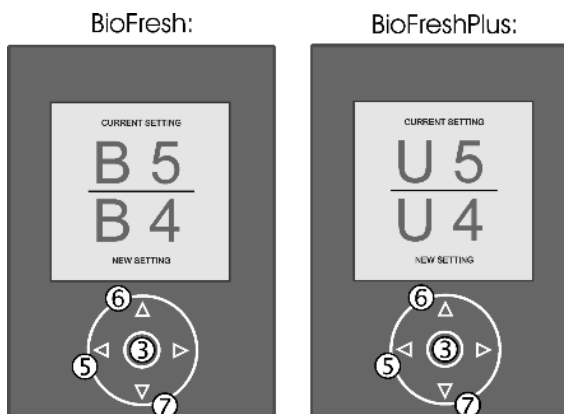

Fig. 29

- ▶ Set the cursor to SETTING.
- ▶ Press OK button Fig. 3 (3).
- ▷ The current setting is shown at the top and the new setting is shown at the bottom in the display.

Note

If the setting is changed in the colder direction, B4 to B1 or U4 to U1*, minus temperatures can be reached.

- ▶ Food can freeze in the BioFresh compartments. Damage due to cold is possible.

- ▶ For a warmer temperature setting (B6 to B9 or U6 to U9*): Press Up button Fig. 3 (6).

-or-

- ▶ For a colder temperature setting (B4 to B1 or U4 to U1*): Press Down button Fig. 3 (7).

- ▶ To accept the setting: Press OK button Fig. 3 (3).
- ▶ To cancel the operation: Press left button Fig. 3 (5).

5.9.9 Setting the humidity in the HydroSafe

- ▶ Low humidity: move the regulator to the left.
- ▶ High humidity: move the regulator to the right.



5.9.10 Drawers

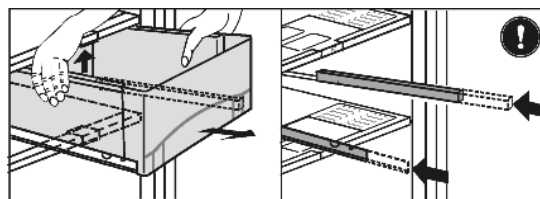

Fig. 30

- ▶ Pull out the drawer, lift it at the back and draw it forwards for removal.
- ▶ Push the rails in again!

Control

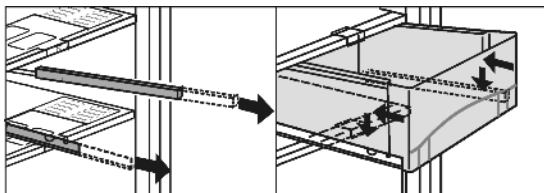

Fig. 31

- ▶ Pull out the rails.
- ▶ Attach the drawer to the rails and push it in until it engages audibly at the back.

5.9.11 Humidity control plate

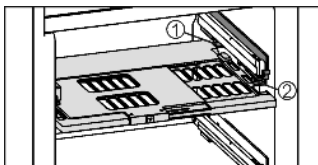

Fig. 32

- ▶ To remove the humidity control plate: Having removed the drawers, carefully draw the plate forwards and lower it for removal.
- ▶ To insert the humidity control plate: Insert the cover mouldings of the plate into the rear holder Fig. 32 (1) from underneath and engage them in the holder Fig. 32 (2) at the front.

5.10 Freezer compartment

You can store frozen food, make ice cubes and freeze fresh food in the freezer compartment.

5.10.1 Freezing food

The maximum weight of fresh food which can be frozen within 24 h is indicated on the type plate under "freezing capacity ... kg/24h".

The maximum load of frozen food for the drawers is 25 kg each and for the shelves 35 kg each.



CAUTION

Risk of injury due to broken glass!
Bottles and cans containing drinks may burst when being frozen. This applies particularly to sparkling drinks.

- ▶ Do not freeze bottles and cans containing drinks!

In order that the food is rapidly frozen through to the core, do not exceed the following quantities per pack:

- Fruit, vegetables up to 1 kg
- Meat up to 2.5 kg
- ▶ Pack the food in portions in freezer bags, reusable plastic, metal or aluminium containers.

5.10.2 Thawing food

- in the refrigerator compartment
- at room temperature
- in a microwave oven
- in a conventional or fan oven
- ▶ Food once thawed should be re-frozen only in exceptional cases.

5.10.3 Adjusting the temperature in the freezer compartment

The appliance is pre-set for normal operation.

The temperature can be set from -16 °C to 26 °C, the recommended temperature is -18 °C.

- ▶ Activate the MAIN MENU.
- ▶ Activate the FREEZER -> TEMPERATURE menu items one after the other.

- ▶ An info text on the recommended freezer temperature appears. Then the current temperature is indicated in the upper section of the display and the temperature desired is indicated in the lower section.

To alter the temperature in 1 °C steps: Press the button briefly.

To change the temperature continuously: Hold down the button.

- ▶ To set a higher temperature: Press Up button Fig. 3 (6).
- ▶ To set a lower temperature: Press Down button Fig. 3 (7).
- ▶ To accept the setting: Press OK button Fig. 3 (3).
- ▶ The freezer temperature slowly adjusts itself to the new value.
- ▶ To cancel the operation: Press left button Fig. 3 (5).

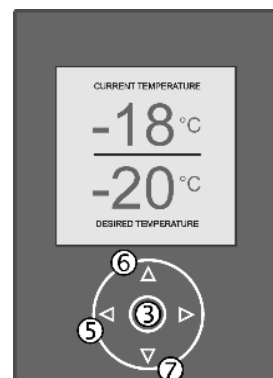

-or-

- ▶ Do not press any button for 10 seconds.

5.10.4 SuperFrost

With this function you can freeze fresh food quickly through to the core. The appliance operates with maximum refrigeration. The noise of the refrigeration unit may be temporarily louder as a result.

The maximum amount of fresh food which can be frozen in 24 h is indicated on the type plate under "freezing capacity ... kg/24h". This amount varies according to the model and climate rating.

Freezing with SuperFrost

You do not have to activate SuperFrost in the following cases:

- when placing frozen food in the freezer
- when freezing up to about 2 kg fresh food daily
- ▶ Activate the MAIN MENU.
- ▶ Activate the FREEZER -> SUPERFROST -> ON menu items one after the other.
- ▶ SuperFrost is activated.
- ▶ The freezer temperature drops, the appliance operates with the maximum refrigerating capacity.
- In case of a small amount of food to be frozen:
 - ▶ wait about 6 h.

-or-

- In case of the maximum amount of food to be frozen:
 - ▶ wait about 24 h.
- In case of a small amount of food to be frozen:
 - ▶ Place the fresh food inside, preferably in the upper compartments.

-or-

- In case of the maximum amount of food to be frozen:
 - ▶ Placed the wrapped food straight onto the shelves and, once frozen, put the food in the drawers.
- ▶ SuperFrost is automatically deactivated. At the earliest after 30 h, at the latest after 60 h, depending on quantity placed inside.
- ▶ Freezing is concluded.
- ▶ The appliance continues to operate in the energy-saving, normal mode.

Deactivating SuperFrost ahead of time

- ▶ Activate the MAIN MENU.
- ▶ Activate the FREEZER -> SUPERFROST -> OFF menu items one after the other.
- ▶ SuperFrost is deactivated.

5.10.5 Drawers

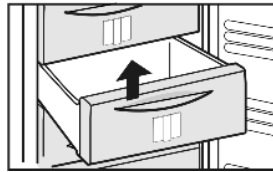

- ▶ To store frozen food directly on the shelves: pull the drawer forwards and lift it out.

5.10.6 Shelves

- ▶ To remove the shelf: lift up at the front and pull out.
- ▶ To put the shelf back: simply push in as far as it will go.

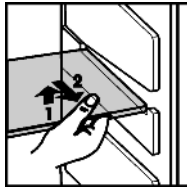

5.10.7 VarioSpace

Apart from being able to remove the drawers, you can also remove the shelves, creating space for large items of frozen food. Poultry, meat, large pieces of game and high bakery products can be frozen in one piece and prepared.

- ▶ The maximum load of frozen food for the drawers is 25 kg each and for the shelves 35 kg each.

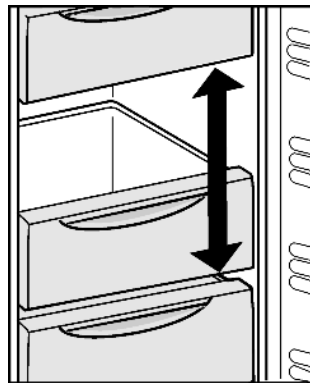

5.10.8 Information system

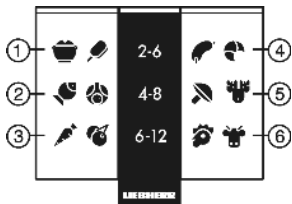

Fig. 33

- | | |
|---------------------------------|------------------------|
| (1) Ready-made meals, ice cream | (4) Sausages, bread |
| (2) Pork, fish | (5) Game, mushrooms |
| (3) Fruit, vegetables | (6) Poultry, beef/veal |

The figures indicate the storage time in months for several types of frozen food in each case. Storage times given are guide times.

5.10.9 Cold storage accumulators

The cold storage accumulators prevent the temperature from rising too fast in the event of power failure.

Using cold storage accumulators

- ▶ Place the cold storage accumulators in the top freezer compartment to save space.
- ▶ Place the frozen cold storage accumulators on the frozen food in the upper front area of the freezer compartment.*

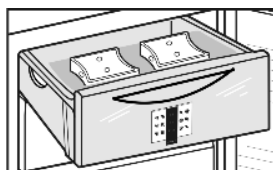

5.10.10 IceMaker



The IceMaker is in the top drawer of the freezer compartment. The drawer is marked "IceMaker".

Make certain that the following conditions are met:

- The appliance is level.
- The appliance is connected.
- The freezer compartment is switched on.
- The IceMaker is connected to the water supply.

Switching on the IceMaker

The water connection of the appliance has to be established.

- ▶ MAIN MENU.
- ▶ Activate the FREEZER -> ICEMAKER -> INFO menu items one after the other.
- ▷ The info text in the display describes what has to be noted for IceMaker use.
- ▶ Press the left button Fig. 3 (5) until ON and INFO are indicated in the display.
- ▶ Activate ON.
- ▷ The IceMaker is switched on.  is indicated in the display.  is indicated if the ice cube compartment is full.

Switching off the IceMaker

- ▶ Activate the MAIN MENU.
- ▶ Activate the FREEZER -> ICEMAKER -> OFF menu items one after the other.
- ▷ The IceMaker is switched off.

Producing ice cubes

The production capacity depends on the freezer temperature. The lower the temperature, the more ice cubes can be produced in a specific period.

The ice cubes drop from the IceMaker into the drawer. When a certain filling level has been reached, no further ice cubes are produced. The IceMaker does not fill the drawer right up to the brim.

If large quantities of ice cubes are needed, the complete IceMaker drawer can be exchanged for the adjacent drawer. When the drawer is closed, the IceMaker automatically recommences production.

Once the IceMaker has been switched on for the first time, it may take up to 24 hours until the first ice cubes are produced.

Note

When the appliance is used for the first time or if has not been used for a long time, the IceMaker has to be rinsed to remove any particles present.

- ▶ Therefore do not use or consume the ice cubes made in the first 24 hours.

Adjusting the water intake time

The opening time of the IceMaker valve can be adjusted if, for example, the water pressure in the line is too low or too high. The water intake time is adjustable in steps from E1 (short intake time) to E8 (long intake time). If the intake time is too long, then e.g. large ice cubes or a block of ice may form, in which case reduce the intake time.

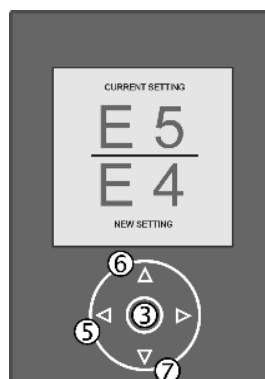

Fig. 34

- ▶ Activate the MAIN MENU.

Maintenance

- ▶ Activate the FREEZER -> ICEMAKER -> WATER INTAKE menu items one after the other.
- ▶ To decrease the water intake time: Press Up button *Fig. 34 (6)*.
- or-
- ▶ To increase the water intake time: Press Down button *Fig. 34 (7)*.

6 Maintenance

6.1 Defrosting with NoFrost

The NoFrost system automatically defrosts the appliance.

Refrigerator compartment:

The defrost water evaporates due to the compressor heat.

- ▶ Regularly clean the drain opening to allow the water to flow away (see 6.2).

Freezer compartment:

The moisture condenses on the evaporator, is periodically defrosted and evaporates.

- ▶ The appliance does not have to be manually defrosted.

6.2 Cleaning the appliance

Before cleaning:



CAUTION

Risk of injury and damage as a result of hot steam!
Hot steam may damage the surfaces and cause burns.

- ▶ Do not use any steam cleaners!

NOTICE

Incorrect cleaning damages the appliance!

- ▶ Do not use cleaning agents in concentrated form.
- ▶ Do not use any scouring or abrasive sponges or steel wool.
- ▶ Do not use any cleaning agents containing sand, chloride, chemicals or acid.
- ▶ Do not use chemical solvents.
- ▶ Do not damage or remove the type plate on the inside of the appliance. It is important for the customer service.
- ▶ Do not pull off, bend or damage cables or other components.
- ▶ Do not allow any cleaning water to enter the drain channel, ventilation grille or electrical parts.

- ▶ Empty the appliance.
- ▶ Pull out the plug.
- Use soft cleaning cloths and a multi-purpose cleaning agent with neutral pH value.
- Only use food compatible cleaning and care agents on the inside of the appliance.
- ▶ Regularly clean ventilation grilles.
- ▷ Dust deposits increase energy consumption.



Outside surfaces and interior:

- ▶ Clean the plastic surfaces, outside and inside, by hand using lukewarm water and a little washing-up liquid.

NOTICE

The stainless steel doors are provided with a high-quality surface coating and must not be treated using the accompanying care product.



Otherwise the surface coating will be affected.

- ▶ Wipe the coated **door surfaces** using a soft, clean cloth only. In case of stubborn dirt, use a little water or a neutral cleaning agent. A microfibre cloth can be optionally used.
- ▶ If the **stainless steel side walls** are dirty, clean them using a commercially available stainless steel cleaning agent. Then evenly apply the accompanying stainless steel care product, making strokes in the direction of the grain.
- ▶ Wipe **side walls with a paint finish** using a soft, clean cloth only. In case of stubborn dirt, use a little water or a neutral cleaning agent. A microfibre cloth can be optionally used.

- ▶ To clean the drain opening: remove any deposits with a fine instrument, e.g. a cotton bud.

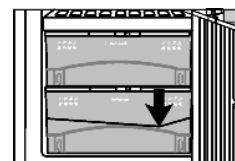

Items of equipment:

- ▶ Clean items of equipment by hand with lukewarm water and a little washing-up liquid.
- ▶ For cleaning, remove the support rails for the half-sized glass shelves.
- ▶ To dismantle the shelves: remove the trims and side parts.
- ▶ To dismantle the storage rack: remove the protective film from the decorative trims.

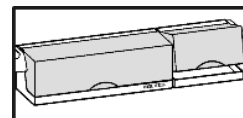
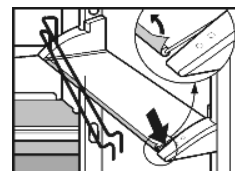

After cleaning:

- ▶ Wipe dry the appliance and items of equipment.
- ▶ Connect the appliance and switch it on again.
- ▶ Switch on SuperFrost (see 5.10.4).

6.3 Cleaning the IceMaker

The ice cube container has to be empty and slid into place.

- ▶ Activate the MAIN MENU.
- ▶ Activate the FREEZER -> ICEMAKER -> TWISTCLEAN menu items one after the other.
- ▶ Set the cursor to INFO.
- ▶ Press OK button *Fig. 3 (3)*.
- ▷ The info text in the display describes the use of the TwistClean function.
- ▶ Press the left button *Fig. 3 (5)* until START and INFO are indicated in the display.
- ▶ Set the cursor to START.
- ▶ Press OK button *Fig. 3 (3)*.
- ▷ TwistClean appears in the display at the bottom, the IceMaker moves into cleaning position.
- When TWISTCLEAN goes out in the display:
 - ▶ Remove ice cube container and clean with warm water and a little washing-up liquid.
 - ▶ Slide ice cube container back into place.

Either leave the IceMaker switched off in this position or switch it on again via MAIN MENU -> FREEZER -> ICEMAKER -> ON.

6.4 Changing the interior light with bulb*

Bulb data

T25 tube, Philips
 max. 25 W
 Fitting: E14
 Type of current and voltage must conform with the details on the type plate

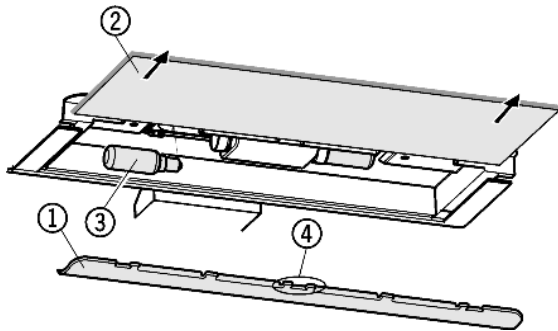

Fig. 35

- ▶ Switch off the appliance.
- ▶ Pull out the power plug or switch off the fuse.
- ▶ To remove the cover Fig. 35 (1): put your finger behind the cover and disengage it.
- ▶ Pull out the glass shelf Fig. 35 (2).
- ▶ Change the bulb Fig. 35 (3).
- ▶ Slide the glass shelf back in.
- ▶ Attach the cover again, engage it at the right and left and pay attention that the middle hook Fig. 35 (4) grips over the glass shelf.

6.5 Customer service

First check whether you can correct the fault yourself by reference to the list (see Malfunzion). If this is not the case, please contact the customer service whose address is given in the enclosed customer service list.



WARNING

Risk of injury if repair work is not carried out professionally!

- ▶ Have any repairs to and intervention in the appliance and mains power cable, which are not expressly mentioned in the (see Maintenance) carried out by the customer service only.

- ▶ Read the appliance designation Fig. 36 (1), service No. Fig. 36 (2) and serial No. Fig. 36 (3) off the type plate located inside the appliance on the left-hand side.

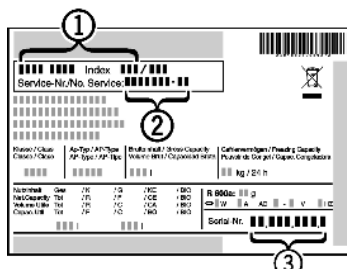

Fig. 36

- ▶ Notify the customer service, specifying the fault, appliance designation Fig. 36 (1), service No. Fig. 36 (2) and serial No. Fig. 36 (3).
- ▷ This will help us to provide you with a faster and more accurate service.
- ▶ Keep the appliance closed until the customer service arrives.
- ▷ The food will stay cool longer.
- ▶ Pull out the mains plug (not by pulling the connecting cable) or switch off the fuse.

7 Malfunzion

Your appliance is designed and manufactured for a long life span and reliable operation. If a malfunction nonetheless occurs during operation, check whether it is due to a handling error. In this case you will have to be charged for the costs incurred, even

during the warranty period. You may be able to rectify the following faults yourself:

Appliance does not work.

- The appliance is not switched on.
- ▶ Switch on the appliance.
- The power plug is not properly inserted in the wall socket.
- ▶ Check power plug.
- The fuse of the wall socket is not in order.
- ▶ Check fuse.

The compressor runs for a long time.

- The compressor switches to a low speed when little cold is needed. Although the running time is increased as a result, energy is saved.
- ▶ This is normal in energy-saving models.
- SuperFrost is activated.
- ▶ The compressor runs for longer in order to rapidly cool the food. This is normal.
- SuperCool is activated.
- ▶ The compressor runs for longer in order to rapidly cool the food. This is normal.

Excessive noise.

- Speed-controlled* compressors may produce varying running noise due to different speed steps.
- ▶ The sound is normal.

A bubbling and gurgling noise.

- This noise comes from the refrigerant flowing in the refrigeration circuit.
- ▶ The sound is normal.

A quiet clicking noise.

- The noise is produced whenever the refrigeration unit (motor) automatically switches on or off.
- ▶ The sound is normal.

A hum. It is briefly a little louder when the refrigeration unit (the motor) switches on.

- The refrigeration increases automatically when the SuperFrost, function is activated, fresh food has just been placed in the appliance or the door has been left open for a while.
- ▶ The sound is normal.
- The refrigeration increases automatically when the SuperCool function is activated, fresh food has just been placed in the appliance or the door has been left open for a while.
- ▶ The sound is normal.
- The ambient temperature is too high.
- ▶ Solution: (see 1.2)

A low hum.

- The sound is produced by air flow noise of the fan.
- ▶ The sound is normal.

Vibratory noise.

- The appliance is not standing firmly on the floor. As a result, adjoining units or objects are set into vibration by the running refrigeration unit.
- ▶ Move the appliance away a little and align it using the adjustable feet.
- ▶ Move bottles and containers apart.

Flow sound at the soft stop mechanism.*

- The noise is produced when the door is opened and closed.
- ▶ The sound is normal.

The temperature display indicates: F0 to F9

- There is a fault.
- ▶ Contact the customer service. (see Maintenance).

The temperature display reads:FE

- There is a fault.
- ▶ Contact the customer service. (see Maintenance).

Decommissioning

The display indicates: POWER FAILURE. The audible alarm sounds.

- The freezer temperature rose too high over the last hours or days due to a power failure or power interruption.
- ▶ To switch off the warning bleep: press OK button *Fig. 3 (3)*.
- ▷ The display indicates the freezer temperature again.
- ▶ If POWER FAILURE continues to be displayed: Contact the customer service. (see Maintenance).
- ▶ Check the quality of the food. Do not consume spoiled food.

The IceMaker cannot be switched on.

- The appliance and therefore the IceMaker are not connected.
- ▶ Connect the appliance. (see Putting into operation).

The IceMaker does not make any ice cubes.

- The IceMaker is not switched on.
- ▶ Switch on the IceMaker.
- The drawer of the IceMaker is not properly closed.
- ▶ Close the drawer properly.
- The water connection is not open.
- ▶ Open the water connection.

The IceMaker symbol flashes.

- There is a fault.
- ▶ Contact the customer service.

The display indicates: CHECK WATER SUPPLY. The audible alarm sounds.

- A fault of the IceMaker has occurred.
- ▶ To switch off the warning bleep: press OK button *Fig. 3 (3)*.
- ▷ The temperature and fault of the IceMaker are indicated in the display.
- ▶ Check whether a handling error has been made.
- ▶ If the fault cannot be corrected: Contact the customer service. (see Maintenance).

The display indicates: ICE CUBE TRAY CANNOT BE EMPTIED. The audible alarm sounds.

- A fault of the IceMaker has occurred.
- ▶ To switch off the warning bleep: press OK button *Fig. 3 (3)*.
- ▷ The temperature and fault of the IceMaker are indicated in the display.
- ▶ Check whether a handling error has been made.
- ▶ If the fault cannot be corrected: Contact the customer service. (see Maintenance).

The display indicates: SENSOR FAULT. The audible alarm sounds.

- A fault of the IceMaker has occurred.
- ▶ To switch off the warning bleep: press OK button *Fig. 3 (3)*.
- ▷ The temperature and fault of the IceMaker are indicated in the display.
- ▶ Check whether a handling error has been made.
- ▶ If the fault cannot be corrected: Contact the customer service. (see Maintenance).

The display indicates: MECHANICAL FAULT. The audible alarm sounds.

- A fault of the IceMaker has occurred.
- ▶ To switch off the warning bleep: press OK button *Fig. 3 (3)*.
- ▷ The temperature and fault of the IceMaker are indicated in the display.
- ▶ Check whether a handling error has been made.
- ▶ If the fault cannot be corrected: Contact the customer service. (see Maintenance).

The temperature is not cold enough.

- The door of the appliance is not properly closed.
- ▶ Close the door of the appliance.
- Insufficient ventilation.
- ▶ Clear ventilation grilles.
- The ambient temperature is too high.
- ▶ Solution: (see 1.2).
- The appliance was opened too frequently or for too long.

- ▶ Wait until the appliance reaches the required temperature itself. If not, contact the customer service. (see Maintenance).
- Too much fresh food was placed inside without SuperFrost.
- The temperature is incorrectly set.
- ▶ Set to a colder temperature and check after 24 h.
- The appliance is too close to a heat source.
- ▶ Solution: (see Putting into operation).

The interior light is not on.

- The appliance is not switched on.
- ▶ Switch on the appliance.
- The door was open longer than 15 min.
- ▶ The interior light automatically switches off if the door has been open for about 15 min.
- If the interior light is not on but the temperature display is lit, the bulb is faulty.*
- ▶ Change the bulb. (see Maintenance).*
- The LED lighting is defective or the cover is damaged:*



WARNING*

Risk of injury due to electric shock!

Live parts are located under the cover.

- ▶ Have the LED interior light changed or repaired only by the customer service or by specialized personnel trained for the purpose.



WARNING*

Danger of injury due to laser radiation, class 1M.

- ▶ Do not look inside when the cover is open.

8 Decommissioning

8.1 Switching off the appliance

Note

- ▶ To switch off the entire appliance, it is necessary only to switch off the freezer compartment. In so doing, the refrigerator compartment is automatically switched off as well.

8.1.1 Switching off the freezer compartment

The refrigerator compartment is automatically switched off as well!

- ▶ Activate the main menu.
- ▶ Activate the FREEZER menu.
- ▶ Set the cursor to ON/OFF.
- ▶ Press OK button *Fig. 3 (3)*.
- ▶ Set the cursor to INFO.
- ▶ Press OK button *Fig. 3 (3)*.
- ▷ The info text in the display describes how to switch the freezer compartment on and off.
- ▶ Press the left button *Fig. 3 (5)* the number of times needed until OFF and INFO are indicated in the display.
- ▶ Set the cursor to OFF.
- ▶ Press OK button *Fig. 3 (3)*.
- ▷ The freezer compartment is switched off.
- ▷ The appliance is switched off.

8.2 Taking the appliance out of service

- ▶ Empty the appliance.
- ▶ Put the IceMaker in the cleaning position (see Maintenance).
- ▶ Switch off the appliance (see Decommissioning).

- ▶ Pull out the power plug.
- ▶ Clean the appliance (see 6.2) .



- ▶ Leave the door open to prevent odour.

9 Disposing of the appliance

The appliance contains some reusable materials and should be disposed of properly - not simply with unsorted household refuse. Appliances which are no longer needed must be disposed of in a professional and appropriate way, in accordance with the current local regulations and laws.



When disposing of the appliance, ensure that the refrigeration circuit is not damaged to prevent uncontrolled escape of the refrigerant it contains (data on type plate) and oil.

- ▶ Disable the appliance.
- ▶ Pull out the plug.
- ▶ Cut through the connecting cable.

