

**Gebrauchsanweisung** für Tischkühlschrank

D

**Instructions for Use** for Table-Top Refrigerator

GB

**Consignes d'utilisation** pour réfrigérateur de table

F

**Gebruikshandleiding** voor tafelkoelkast

NL

**Istruzioni per l'uso** del frigorifero da tavolo

I

**Instrucciones de manejo** para frigoríficos "Table-Top"

E

**Instruções de utilização** para frigorífico de mesa

P

**Masa dondurma dolabının** kullanım kılavuzu

TR

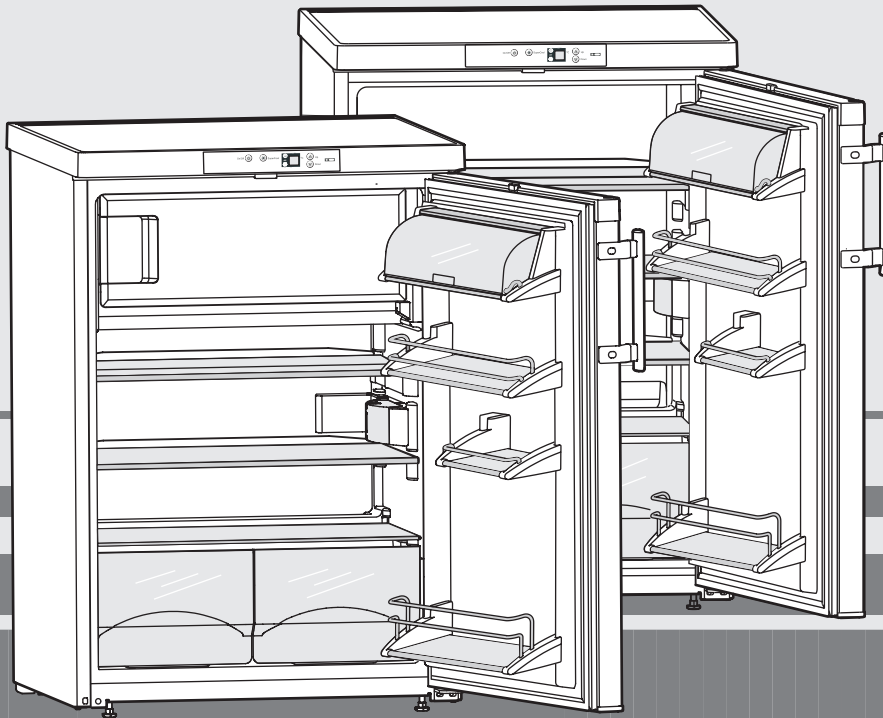

7081 879-01

KTP/KTPesf 17../15..

0111

# The appliance at a glance

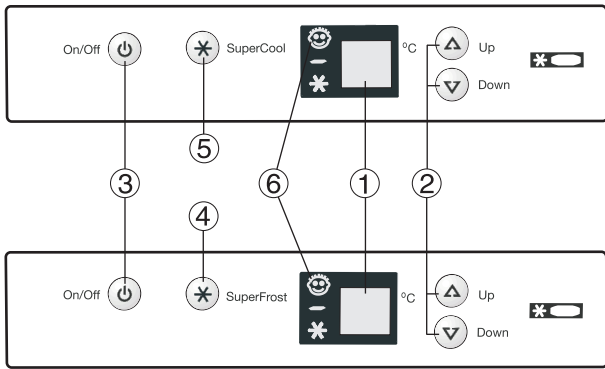

## Operating controls Fig. A1

- ① Temperature and set up display,
- ② Adjustment buttons for temperature:  
UP = warmer, DOWN = colder,
- ③ On/off button
- ④ SuperFrost-button\*,  
- for quick freeze of large amounts of fresh food.
- ⑤ SuperCool button\* - for quick cool down of fresh food
- ⑥ Child safety lock display, to prevent unintended turn off. More information in 'auxiliary functions' section.

## A1

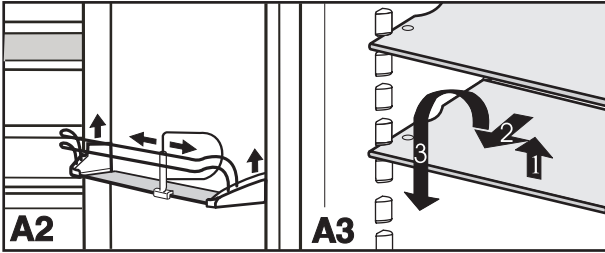

- By moving the **bottle and jar holder**, you can prevent bottles from tipping over when the door is opened and closed. The holder can be removed for cleaning.

- You can remove all **door racks** for cleaning, fig. **A2**: Lift rack and pull forwards.

- **The shelves\*** can be adjusted according to height of frozen food, fig. **A3**.

- Lift the shelf, slide forwards and remove.

- Always insert shelves with the raised edge at the back pointing upwards, otherwise food may freeze onto the rear wall.

- Fig. **A4**: If you need space for large bottles and containers, then simply push the front half of glass shelf ① back. For cleaning, the holder ② can be used to remove the half glass shelves.

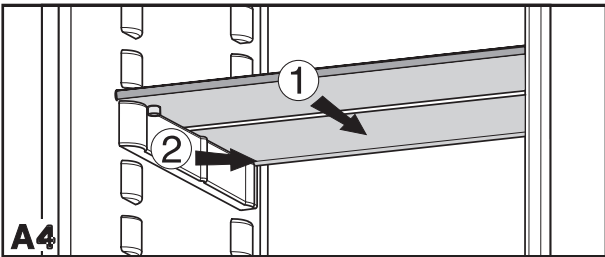

## A4

## Description of the appliance and equipment Fig. A

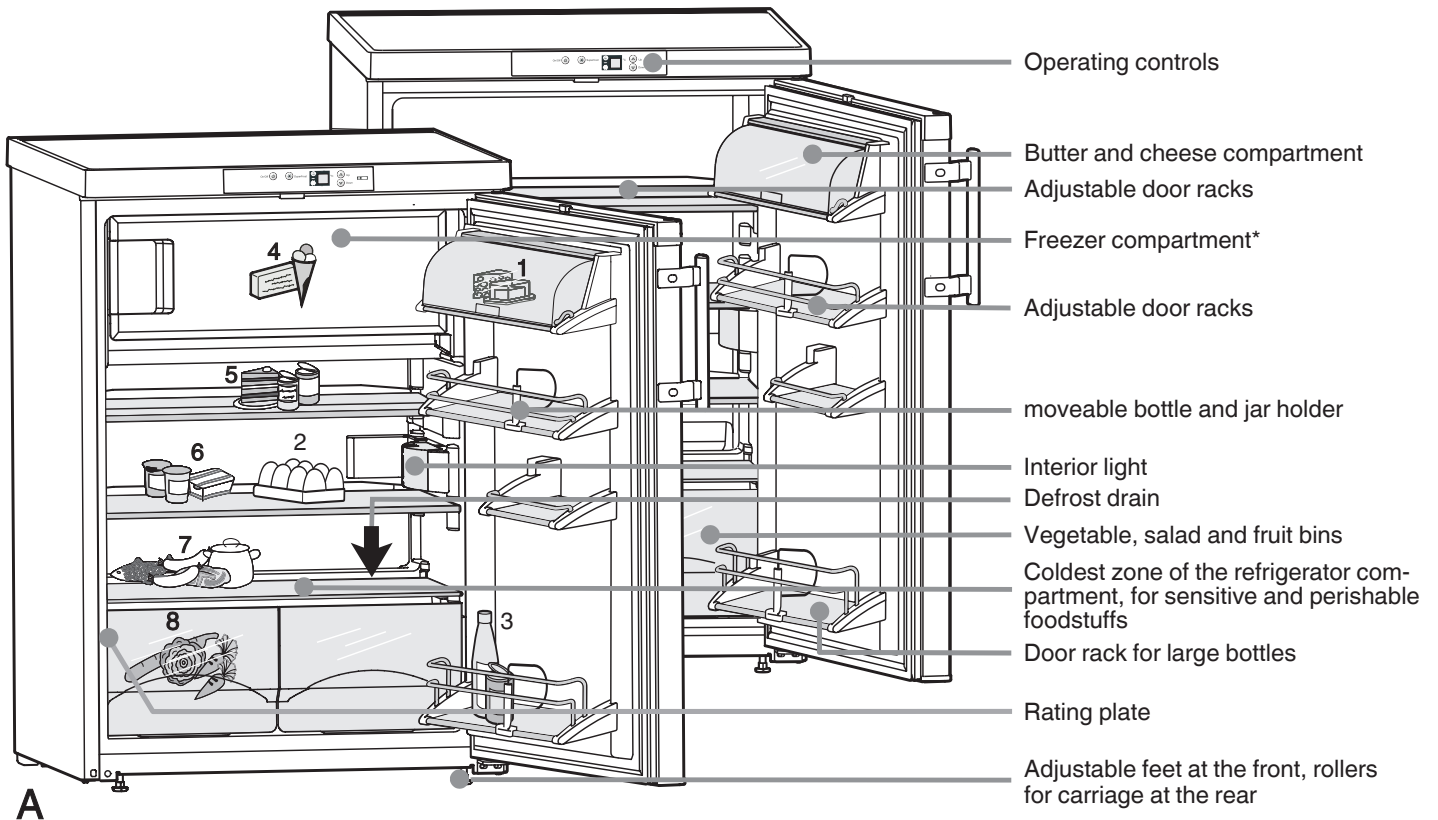

Operating controls

Butter and cheese compartment

Adjustable door racks

Freezer compartment\*

Adjustable door racks

moveable bottle and jar holder

Interior light

Defrost drain

Vegetable, salad and fruit bins

Coldest zone of the refrigerator compartment, for sensitive and perishable foodstuffs

Door rack for large bottles

Rating plate

Adjustable feet at the front, rollers for carriage at the rear

## A

\* according to Model and design

We congratulate you on your new machine. With your purchase you have decided on all the advantages of the most modern refrigeration technology, which guarantees you high quality, durability and high functional safety.

The features on your appliance have been designed to ensure maximum convenience - day in, day out. This appliance has been manufactured with recyclable materials using an environmentally friendly process, so together you and we are making an active contribution to the preservation of our environment.

To familiarise yourself with all the advantages your new appliance has to offer, please read the information contained in these operating instructions carefully. Read through the instructions for use carefully.

We wish you much pleasure with your new appliance.

<b>Contents</b>	<b>Page</b>
<b>Operating instructions</b>	
The appliance at a glance .....	8
Contents .....	9
Example of food arrangement .....	9
Conditions .....	9
Saving energy .....	9
Safety instructions and warnings .....	10
Disposal notes .....	10
Technical safety .....	10
Safety during use .....	10
Setting up .....	10
Connecting to the mains .....	10
Putting into operation .....	11
Switching the appliance on and off .....	11
Setting the temperature .....	11
Temperature Setting Indicator .....	11
Additional functions .....	11
<b>Refrigerator compartment</b> .....	<b>11</b>
SuperCool* .....	11
The interior light .....	11
Notes on refrigerating .....	12
Freezer compartment* .....	12
SuperFrost .....	12
Freezing with SuperFrost .....	12
Notes on freezing and storage .....	12
Making ice-cubes .....	12
Defrosting, cleaning .....	12
Troubleshooting .....	13
Customer service and type plate .....	13
<b>Instructions for installation and modification</b>	
Setup Dimensions .....	13
Changing over door hinges .....	13

**Example of food arrangement, Fig. A**

- 1 Butter, Cheese
- 2 Eggs
- 3 Bottles and Jars
- 4 In the freezer compartment\*: Frozen Food, Ice Cubes
- 5 Jams, Bakery Goods
- 6 Dairy Products
- 7 Meat, Fish, Sausages, Ready Meals
- 8 Vegetables, Salads, Fruit

**Note**

- Place food inside the appliance as shown in the diagram. This allows the appliance to save energy during operation.
- Shelves, drawers and baskets are arranged for optimum energy efficiency on delivery.

Keep these operating instructions in a safe place and pass them on to the next owner, where applicable. The operating instructions apply to several models. Differences may therefore occur.

**Conditions**

- The device is designed exclusively for the cooling food-stuffs. The applicable statutory regulations are to be observed in the event that the device is to be used for commercial cooling of foodstuffs. The device is not suitable for the storage and cooling of drugs, blood plasma, laboratory preparations or similar medicine-related materials and products as detailed in the Medical Devices Directive 2007/47/EC. Improper use of the device can cause the stored products stored in it to be damaged or the items can be spoiled. In addition, the device is not suitable for operation in explosion-prone areas.
- The device is designed for operation in limited ambient temperatures according to the climate classification. It should not be operated outside these limits. The climate class applicable for your equipment is printed on the rating plate. It means:

climate class	designed for ambient temperatures of
SN	+10 °C to +32 °C
N	+16 °C to +32 °C
ST	+16 °C to +38 °C
T	+16 °C to +43 °C

- The refrigerant circuit is checked for leaks.
- The appliance complies with current safety regulations and EC directives 2006/95/EC and 2004/108/EC.

**Saving energy**

- Always ensure good ventilation. Do not cover ventilation openings or grille.
  - Do not place appliance in areas of direct sunlight or next to a stove, heater or similar object.
  - The energy consumption depends on the installation conditions, e.g. the ambient temperature.
  - Keep the time the appliance is open to a minimum.
  - The lower the temperature setting, the higher the power consumption.
  - Store food logically. (see Appliance at a glance).
  - Ensure that all food is well packed and covered for storage. This will prevent frost from forming.
  - Remove food as needed in order that it does not warm too much.
  - First cool warm food to room temperature before storing it.
  - Defrost frozen food in the refrigerator.
  - If there is a thick layer of frost in the appliance: defrost the appliance.
- Accumulated dust increases the energy consumption:
- Once a year, dust the refrigerating unit together with the metal grille of the heat exchanger at the back of the appliance.



\* according to Model and design

# Safety instructions and warnings

## Disposal notes

The packaging is made of recyclable materials.



- Corrugated board/board
- EPS moulded parts
- Polythene sheets
- Polypropylene straps

- **Keep packaging materials away from children - polythene sheets and bags can cause suffocation!**

- Please return the packaging to an official collection point.

**Your old appliance:** This contains some reusable materials and should be disposed of properly - not simply with unsorted household refuse.



- Discarded appliances should be disabled: Remove the plug, cut through the connection cable and render the catch unusable so that children cannot become trapped inside.
- Ensure that the refrigerant circuit is not damaged when the appliance that is no longer needed is taken away for disposal.
- Details of the refrigerant can be found on the type plate.
- Appliances which are no longer needed must be disposed of in a professional and appropriate way, in accordance with the current local regulations and laws.

## Technical safety

- To prevent injury or damage to the unit, the appliance should only be transported wrapped and set up by two people.
- The refrigerant R 600a is environmentally friendly but flammable.
- Do not damage the refrigerant circuit pipes. Splashes of refrigerant can harm your eyes or ignite.
- If refrigerant escapes, remove all naked flames or sources of ignition in the vicinity of the leak, disconnect the appliance from the mains and ventilate the area well.
- In the event that the appliance is damaged, contact the supplier immediately before connecting to the mains.
- To guarantee safe operation, ensure that the appliance is set up and connected as described in these operating instructions.
- In the event of a fault, disconnect the appliance from the mains: disconnect mains plug (do not pull on the connection cable) or trigger or unscrew fuse.
- **Any repairs and work on the appliance should only be carried out by the customer service department, as unauthorised work could prove highly dangerous for the user.** The same applies to changing the mains power cable.



## Safety during use

- Do not store explosives or sprays using combustible propellants such as butane, propane, pentane, etc. in the appliance. Electrical components might cause leaking gas to ignite. You can identify such sprays by the printed contents or a flame symbol.
- Only store high-percentage alcohol in tightly sealed, upright containers.
- Do not allow naked flames or ignition sources to enter the appliance.
- Do not use electrical appliances inside the appliance (e.g. steam cleaners, heaters, ice makers, etc.).
- Do not stand on the plinth, drawers or doors or use them to support anything else.



- Do not let children play with the appliance, e.g. do not allow them to sit in the drawers or swing on the door. This appliance is not intended for use by persons (including children) with reduced physical, sensory or mental capabilities or lack of experience and knowledge unless they have been given initial supervision or instruction concerning use of the appliance by a person responsible for their safety. Children should be supervised to ensure that they do not play with the appliance.
- Avoid prolonged skin contact with cold surfaces or chilled/frozen food. This could cause pain, numbness and frostbite. Protect against long-term contact with the skin, e.g. wear gloves.
- Do not consume food which has been stored for too long, as it could cause food poisoning.
- Special-purpose lamps (incandescent lamps, LEDs, fluorescent tubes) in the appliance serve to illuminate the appliance interior and are not suited for room illumination.

## Setting up

- When setting up/fitting ensure that the refrigerant circuit pipes are not damaged.
- Once in position, use a 10 spanner to adjust the feet so that the appliance is level and does not wobble.
- Standard EN 378 specifies that the room in which you install your appliance must have a volume of 1 m<sup>3</sup> per 8 g of R 600a refrigerant used in the appliance, so as to avoid the formation of inflammable gas/air mixtures in the room where the appliance is located in the event of a leak in the refrigerant circuit. The quantity of refrigerant used in your appliance is indicated on the type plate on the inside of the appliance.
- Always position the appliance directly up against the wall.
- **The ventilation grilles should not be obstructed.** Observe the appendix to the installation and modification instructions.
- Condensation may form on the outside of the refrigerator/freezer during periods of high humidity. Constant ventilation of the installation site is recommended.
- Do not place heat-emitting appliances, e.g. microwave oven, toaster, etc., on top of the refrigerator or freezer.
- Keep burning candles, lamps and other items with naked flames away from the appliance so that they do not set the appliance on fire.
- Fire hazard due to dampness!  
If live parts or the mains lead become damp this may cause short circuits.
- The appliance is designed for use in enclosed areas. Do not operate the appliance outdoors or in areas where it is exposed to splash water or damp conditions.
- CAUTION! Risk of injury and danger of damage as a result of incorrect transport!
  - Transport the appliance in a packed condition.
  - Transport the appliance upright.
  - Do not transport the appliance without assistance.
- The appliance may be moved only when it is empty.

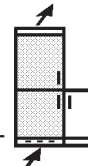

## Connecting to the mains Power supply (AC) and voltage

at the operating point must comply with the details on the rating plate, which is located on the inside left of the appliance, next to the vegetable bins.

- Connect the appliance with a properly earthed fused plug and socket only.
- The socket must be fused with a 10 A fuse or higher, it must be away from the rear of the appliance and must be easily accessible.
- Do not connect the appliance to the supply with other equipment using a distribution outlet - risk of overheating.
- When removing the mains cable from the back of the appliance, remove the cable holder as well so as to avoid vibration noise.



\* according to Model and design

# Putting into operation and control elements

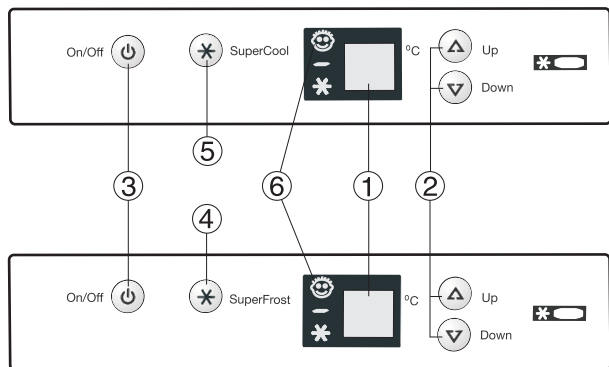

## A1

You are advised to clean the appliance before switching it on for the first time, see "Cleaning".

### Switching the appliance on and off, Fig. A1

- **Switching on:** Press the on/off button (3) so that the temperature display lights up/flashes.
  - At start up and as long as the unit is warm, the room temperature is shown first until the desired temperature is reached.
  - The Lighting\* will light up when the door is open.
- **Switching off:** Press the on/off button for approx. two seconds so that the temperature display goes out.

### Setting the temperature

- **To reduce the temperature:** Press the DOWN button (2).
  - **To increase the temperature:** Press the UP button (2).
    - While you are entering the temperature, the **set temperature will flash** on the display.
    - When you press the temperature setting buttons for the first time, the **most recent setting** (known as the "reference setting") is displayed.
    - You can change the settings in increments of 1°C by briefly pressing the buttons again. If the buttons are held down the temperature setting will change faster.
    - Approx. 5 seconds after the last button was pressed, the electronic switches over automatically and the actual cooling temperature (= actual value) is shown.
    - The temperature can be set at between 2 °C and 9 °C. Whether you can obtain the lowest temperature depends on where the appliance is positioned (if it is located in an area with a high ambient temperature it will not reach the lowest temperature).
  - **Recommended temperature settings:**
    - For the **refrigerator compartment:** 5 °C
- For appliances with **freezer compartment\*** the following is true:
- If frozen food is stored and low compartment temperatures are guaranteed, the temperature control setting between 2 °C and 5 °C is recommended.
  - When the ambient temperatures are below 18 °C, the winter heating of the device switches on automatically.

**Note:** Please note that the temperature inside the appliance is affected by the frequency with which the door is opened, how full the appliance is and the room temperature at the place where the appliance is installed.

### Temperature setting display, Fig. A1/1

In normal operation, the actual cooling temperature is shown.

#### The display will flash:

- if you change the temperature
- If "F 1" to "F 5" appears in the display, the appliance has a fault. Consult the customer service department indicating the fault number displayed as this will tell the technician what kind of irregularity has occurred.
- The illuminated temperature setting display indicates operation of the appliance.

- Temperature ranges are allocated to the individual LEDs. They indicate the selected setting of the refrigerating/ freezing temperature.

GB

### Additional functions

In set-up mode you can set the **child-proof lock** and adjust the **brightness of the display\***:

#### Activating set-up mode:

- Press SuperFrost button for approx. 5 secs - the SuperFrost button flashes - the display shows **c** for child-proof lock. Note: the value to be altered flashes.
- Select the required function by pressing the Up/Down button: **c = child-proof lock** or **h = brightness**.
- Now select/acknowledge function by pressing SuperFrost button briefly:
  - For **c = child-proof lock**, press the Up/Down button to select **c1 = child-proof lock on** or **c0 = child-proof lock off** and acknowledge with the SuperFrost button. When the symbol (6) is lit, the child-proof lock is activated.
  - For **h = brightness**, press Up/Down button to select **h1 = minimum** to **h5 = maximum** brightness and acknowledge with the SuperFrost button.



#### Exit set-up mode:

- To exit the set-up mode, press the On/Off button; after 2 mins. the electronic system switches over automatically.
- The normal operating mode is activated again.

## Refrigerator compartment

### SuperCool\*, Fig. A1/5

SuperCool is particularly recommended for when you want to cool large quantities of freshly stored food or drinks as quickly as possible. The refrigeration temperature then decreases the value of the coldest temperature performance.

- **Switching On and Off:** Briefly press SuperCool button (5), lighting up the appropriate LED (dark= off).

**Note:** SuperCool consumes more energy.

However, after about 6 seconds the electronics automatically switch back to energy-saving normal operation.

### The interior light

switches off automatically when door is open for more than approx. 15 minutes. If the lamp does not light up when the door is opened briefly, but the temperature setting display does, the light bulb may be defective.

#### Replacing the bulb:

- **Light-bulb specifications:** max. 15 W, power supply and voltage should match the details on the rating plate. Only use light bulbs with the same dimensions, fitting: E 14.
- Switch off the appliance. **Disconnect mains plug or trip or unscrew fuse.**
- Push the sides 1 of the lamp cover together according to Fig. F1, unlatch and detach at rear 2.
- Replace the light bulb according to Fig. F2.
- Attach the cover at the rear again and lock into place on sides.

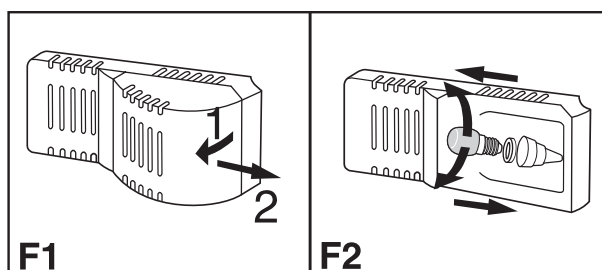

\* according to Model and design

## Notes on refrigerating

- Due to the natural circulation of air in the refrigerator, different temperature areas are set, which are suitable for storing different types of food.
- Immediately above the vegetable bins and on the rear wall is the coldest (e.g. suitable for sausages and meat products);
- In the top front area and in the door is the warmest (e.g. suitable for spreadable butter and cheese).
- Food is to be stored so that the air can circulate properly, so do not store things too cramped.
- Food which often gives off or absorbs smells or tastes, and liquids should always be stored in closed containers or covered.
- Reusable plastic, metal, aluminium or glass containers and food wrap are suitable packaging material.
- Food that gives off a large amount of ethylene or are highly sensitive to it such as fruit, vegetables are salads should always be separated or packed so as not to reduce storage life; e.g. do not store tomatoes together with kiwi fruit or cabbage.

## Freezer compartment\*

### Freezer compartment\* \* \*\* \*\*

You can store frozen foods and other frozen goods for several months, at a storage temperature of -18 °C and below (from a medium temperature controller setting) make ice cubes and also freeze fresh food.

**Note:** The air temperature in the compartment, measured with thermometer or other measuring devices, may vary. However, in a full compartment, that has little effect on the frozen goods. The core temperature of the frozen goods therefore is the medium setting for these fluctuations.

### SuperFrost

The fresh food should be frozen through to the core as quickly as possible and already stored frozen goods maintain a cold reserve. This is possible with the SuperFrost equipment. Therefore the nutritional value, appearance and flavour of frozen food is maintained the best.

- As a maximum, you can freeze as many kg of fresh food within 24 hours, as is indicated on the rating plate under "freezing capacity ... kg/24h" ④ . This maximum quantity of frozen goods varies depending on model and climate class.

### Freezing with SuperFrost Fig. A1/④

- press SuperFrost button ④ quickly so that the LED lights up.
- The freezing temperature decreases and the appliance works at the highest possible refrigeration capacity.
- Then insert the fresh food.
- SuperFrost switches off **automatically** after a total of about 65 hours. The fast freeze process is finished,
- The **SuperFrost LED turns off**. The appliance continues to operate in energy-saving mode.

**Note:** You must not turn on SuperFrost:

- when inserting already frozen goods.

## Notes on freezing and storage

- Frozen food (goods that are already frozen) can be inserted into the cold compartment.
- If possible do not put any bottles in the compartment to fast freeze, and if you do, remove them within an hour, otherwise they will burst!
- Do not refreeze food that has already been defrosted, but remake into a prepared dish. The nutrition value and taste will therefore remain the best.
- As a guideline for the storage time, the following applies to various foodstuffs in the freezer compartment:

Ice cream	2 to 6 months
Sausage, ham	2 to 6 months
Bread, cakes and pastries	2 to 6 months
Game, pork	6 to 10 months
Fish, oily	2 to 6 months

Fish, lean	6 to 12 months
Cheese	2 to 6 months
Poultry, beef	6 to 12 months
Vegetables, fruit	6 to 12 months

- The value that is applicable depends on the quality of the food, the preparation before freezing and the quality requirements of the individual household. For food with a high fat content the lower values are always applicable; fats tend to go rancid.

## Making ice-cubes

- **Fill the ice-cube tray\*** three-quarters full with water and freeze. The ice-cubes can be removed from the tray by twisting or by holding upside down for a short time under running water.

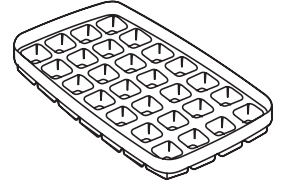

## Defrosting, cleaning

### In the refrigerator

Appliances without freezer compartment defrost automatically. The moisture occurring at the back wall of the refrigerator is carried outside the refrigerator into an evaporating dish through the defrost water channel. The defrost water is evaporated by the compressor heat - water droplets on the rear wall depend on function and are completely normal.

- At least ensure that the defrost water can always flow out of through the outlet hole via the vegetable bin to the rear wall (arrow in Fig. A) unhindered.

### Freezer compartment\*

**Do not use any electrical heating or steam cleaning appliances, defrosting sprays, open flames or metal objects to remove ice. Risk of injury and damage to the appliance.**

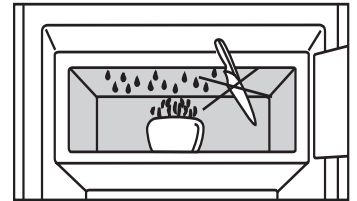

To accelerate the defrosting process, put a pan with warm, not boiling water into the compartment.

How to defrost:

- Switch off the appliance: Disconnect from the mains or
- Press the on/off button for approx. two seconds.
- Remove frozen goods, put into newspaper or blankets and stored in a cool place.
- Leave the compartment and appliance door open during the defrosting process.
- Collect defrosting water with a sponge or cloth. Then clean the appliance.

### Cleaning

- **Before cleaning, always switch off the appliance. Disconnect from the mains or un-screw or switch off the fuse.**
- Clean the outer walls, inside and appliance by hand with lukewarm water and a little detergent. Because of the risk of injury and damage to the appliance, steam cleaning equipment should not be used.
- Use a commercially available stainless-steel cleaning agent for **stainless-steel appliances**.
- In order to achieve best possible protection, apply a stainless-steel care agent only on the door uniformly in grinding direction after cleaning. Points which are darker at the start and a more intensive coloration of the stainless-steel surface are normal.
- Do not use abrasive sponges or scourers, do not use concentrated cleaning agents and never use cleaning agents containing sand, chloride or acid or chemical solvents, as these would damage the surfaces and could cause corrosion.
- We recommend using a soft cloth and an all-purpose cleaner with a neutral pH value. Only use food safe cleaning materials inside the appliance.
- The racks, shelves and other components should be cleaned by hand as they are not dishwasher-safe.



\* according to Model and design



