

**Gebrauchsanweisung** für Kühl-Gefrier-Kombination

**D**

**Operating instructions** for fridge-freezer combination

**GB**

**Consignes d'utilisation** pour combiné réfrigérateur-congérateur

**F**

**Gebruiksaanwijzing** voor koel-vries-combinatie

**NL**

**Istruzione d'uso** per combinazione frigo-congelatore

**I**

**Instrucciones de manejo** para combinado frigorífico-congelador

**E**

**Kullanım Kılavuzu** Soğutucu-Dondurucu-Kombinasyonu

**TR**

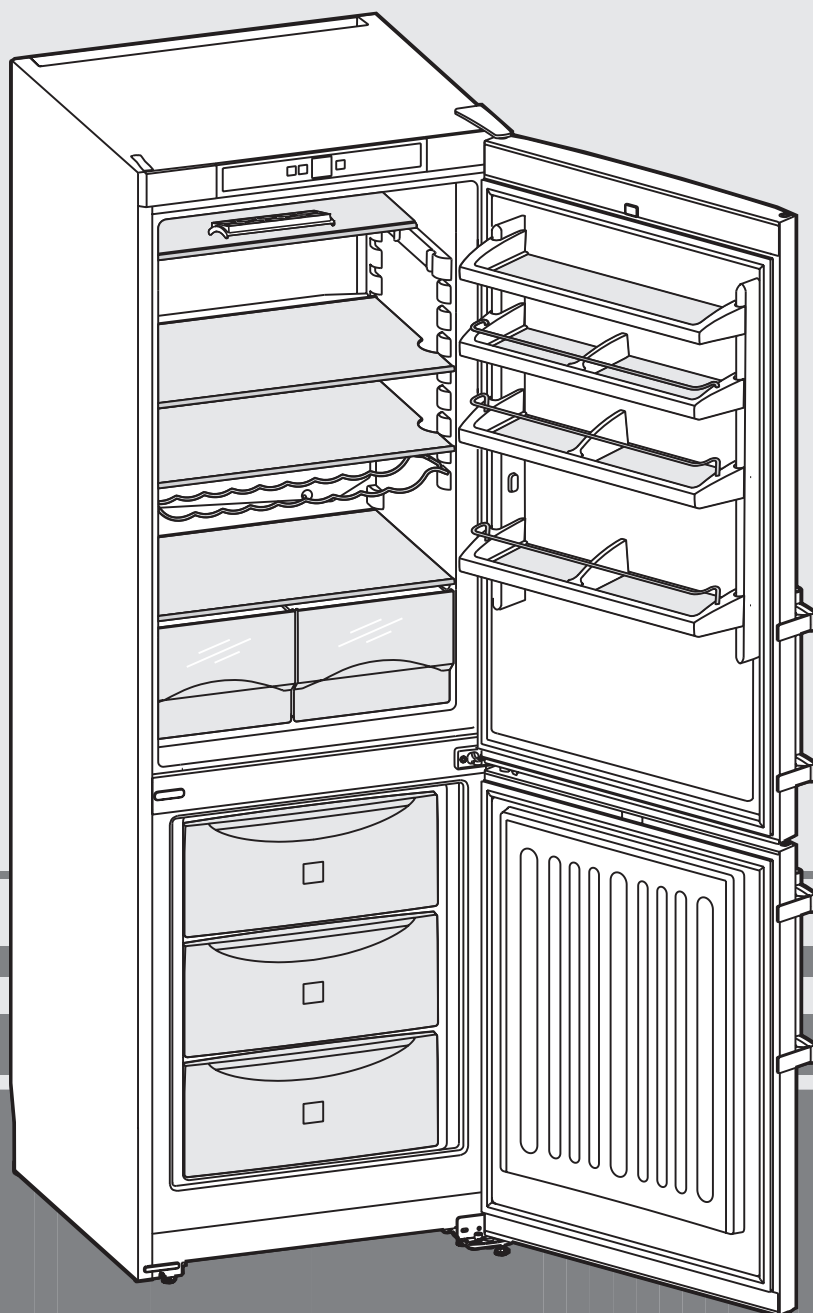

**7081 933-03**

CU/CUP 31../35../40.. 1910

# 1 The appliance at a glance

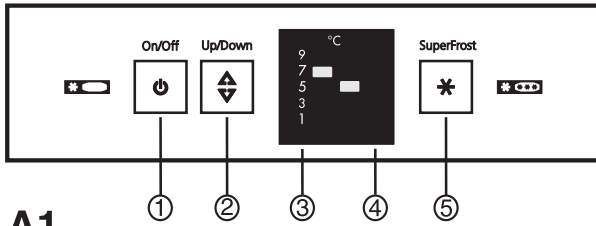

## Operating controls, fig. A1

- ① On/Off button, fridge section
- ② Up/Down button
- ③ Temperature display, fridge section
- ④ Temperature display for freezer section
- ⑤ SuperFrost button

A1

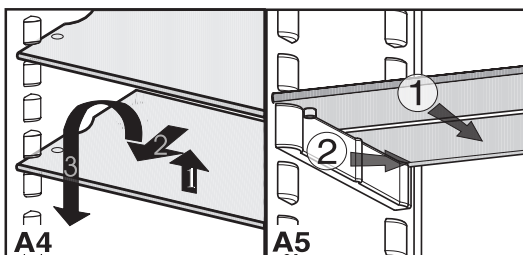
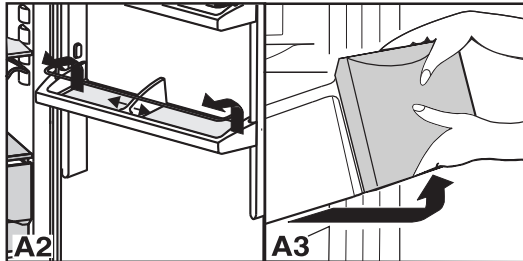

- By moving the **bottle and can holder**, you can prevent bottles from tipping over when the door is opened and closed. The holder can be removed for cleaning:
  - fig. **A2**: The holder slides and releases left or right along the door stops.
  - You can remove all **door racks** for cleaning, fig. **A2**: lift rack and pull forwards.
  - **The shelves\*** can be adjusted according to height of frozen food, fig. **A4**.
    - Lift the shelf, slide forwards and remove.
    - Always insert shelves with the raised edge at the back pointing upwards, otherwise food may freeze onto the rear wall.
  - **Removing drawers**: Pull forward until the drawer stops and lift out, fig. **A3**.
  - Fig. **A5**: If you need space for large bottles and containers, then simply push the front half of glass shelf ① back. For cleaning, the holder ② can be used to remove the half glass shelves.

## Rating plate specifications Fig. A6

- ① Appliance designation
- ② Service number
- ③ Appliance number
- ④ Freezing capacity ... kg/24hrs.

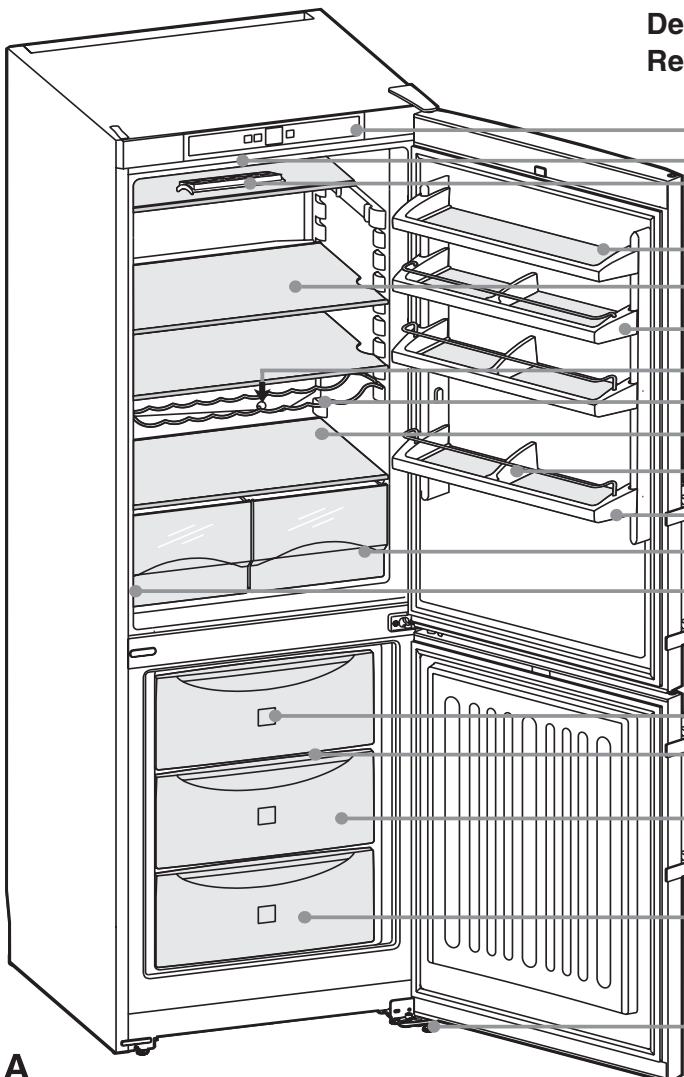
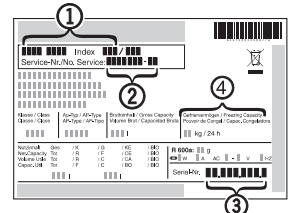

## Description of appliance and equipment, Fig. A

### Refrigerator compartment, approx. 5 °C

- Operating controls
- Ceiling lighting
- Egg tray
- Butter stop
- Adjustable storage shelves
- Adjustable door racks
- Defrost drain
- Bottle shelf\*
- Coldest zone of the refrigerator compartment, for sensitive and perishable foodstuffs
- Adjustable bottle and can holder
- Door rack for large bottles
- Vegetable, salad and fruit bins
- Rating plate

### Freezer compartment, approx. -18 °C

- Information system\*
- VarioSpace\*
- High drawers
- Ice-cube tray\*
- Adjustable-height feet at front, transport castors at back

A  
10

\* depending on model and options

Congratulations on your purchase. Your appliance offers you all the advantages of modern refrigeration technology, guaranteeing you high quality, a long service life and high reliability. The features on your appliance have been designed to ensure maximum convenience - day in, day out.

This appliance has been manufactured with recyclable materials using an environmentally friendly process, so together you and we are making an active contribution to the preservation of our environment.

To familiarise yourself with all the advantages your new appliance has to offer, please read the information contained in these operating instructions carefully.

We wish you much pleasure with your new appliance.

Keep these operating instructions in a safe place and pass them on to the next owner, where applicable. The operating instructions apply to several models. Differences may therefore occur.

<b>Contents</b>	<b>Page</b>
<b>Operating instructions</b>	
<b>1 The appliance at a glance.....</b>	<b>10</b>
Contents.....	11
Safety regulations .....	11
Saving energy .....	11
<b>2 Safety instructions and warnings .....</b>	<b>12</b>
Disposal notes.....	12
Technical safety.....	12
Safety during use .....	12
Setting up.....	12
Connecting to the mains .....	12
<b>3 Putting into operation and controls.....</b>	<b>13</b>
Switching the appliance on and off .....	13
Adjusting the temperature.....	13
Temperature display.....	13
<b>4 Refrigerator compartment .....</b>	<b>14</b>
Arrangement of food.....	14
Interior light .....	14
<b>5 Freezer compartment .....</b>	<b>14</b>
Making ice-cubes .....	14
SuperFrost.....	14
Notes on freezing and storage.....	15
<b>6 Defrosting .....</b>	<b>15</b>
<b>6 Cleaning .....</b>	<b>16</b>
<b>7 Troubleshooting.....</b>	<b>16</b>
Customer service and type plate .....	16
<b>8 Instructions for installation and modification</b>	
Changing over door hinges .....	17
Insertion into row of kitchen units.....	17

## Safety regulations

- The device is designed exclusively for the cooling of foodstuffs. The applicable statutory regulations are to be observed in the event that the device is to be used for commercial cooling of foodstuffs. The device is not suitable for the storage and cooling of drugs, blood plasma, laboratory preparations or similar medicine-related materials and products as detailed in the Medical Devices Directive 2007/47/EC. Improper use of the device can cause the stored products stored in it to be damaged or the items can be spoiled. In addition, the device is not suitable for operation in explosion-prone areas.
- The appliance is set to operate within specific ambient temperature limits according to its climate rating. These temperature limits should not be exceeded. The correct climate rating for your appliance is indicated on the type plate. This is explained as follows:

Climate rating	set for ambient temperatures of
SN	+10°C to +32°C
N	+16°C to +32°C
ST	+16°C to +38°C
T	+16°C to +43°C

- The refrigerant circuit has been tested for leaks.
- The appliance complies with current safety regulations and EC directives 2006/95/EC and 2004/108/EC.

## Saving energy

- Always ensure good ventilation. Do not cover ventilation openings or grille.
- Do not place appliance in areas of direct sunlight or next to a stove, heater or similar object.
- The energy consumption depends on the installation conditions, e.g. the ambient temperature.
- Keep the time the appliance is open to a minimum.
- Store food logically.
- Ensure that all food is well packed and covered for storage. This will prevent frost from forming.
- First cool warm food to room temperature before storing it.
- Defrost frozen food in the refrigerator.
- If there is a thick layer of frost in the appliance: defrost the appliance.

Accumulated dust increases the energy consumption:

- Once a year, dust the refrigerating unit together with the metal grille of the heat exchanger at the back of the appliance.

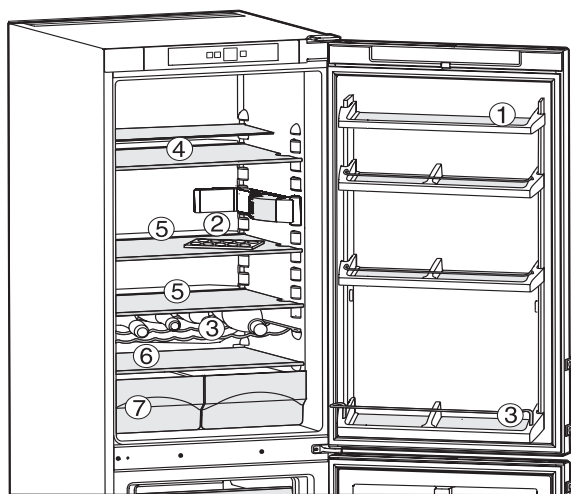

**B**  
**Example of food arrangement** Fig. B

- 1 butter, cheese
- 2 eggs
- 3 cans, drinks, bottles
- 4 preserves, baked goods
- 5 dairy products
- 6 coldest zone of refrigerator compartment: sensitive foods, meat/sausages, fish, raw milk products, convenience foods
- 7 fruit, vegetables, salad

## Note

- Place food inside the appliance as shown in the diagram. This allows the appliance to save energy during operation.
- Shelves, drawers and baskets are arranged for optimum energy efficiency on delivery.

## 2 Safety instructions and warnings

### Disposal notes

The packaging is made of recyclable materials.

- Corrugated board/board
- EPS moulded parts
- Polythene sheets
- Polypropylene straps

- **Keep packaging materials away from children - polythene sheets and bags can cause suffocation!**
- Please return the packaging to an official collection point.

**Your old appliance:** This contains some reusable materials and should be disposed of properly - not simply with unsorted household refuse.

- Discarded appliances should be disabled: Remove the plug, cut through the connection cable and render the catch unusable so that children cannot become trapped inside.
- Ensure that the refrigerant circuit is not damaged when the appliance that is no longer needed is taken away for disposal.
- Details of the refrigerant can be found on the type plate.
- Appliances which are no longer needed must be disposed of in a professional and appropriate way, in accordance with the current local regulations and laws.



### Technical safety

- To prevent injury or damage to the unit, the appliance should only be transported wrapped and set up by two people.
- The refrigerant R 600a is environmentally friendly but flammable.
- Do not damage the refrigerant circuit pipes. Splashes of refrigerant can harm your eyes or ignite.
- If refrigerant escapes, remove all naked flames or sources of ignition in the vicinity of the leak, disconnect the appliance from the mains and ventilate the area well.
- In the event that the appliance is damaged, contact the supplier immediately before connecting to the mains.
- To guarantee safe operation, ensure that the appliance is set up and connected as described in these operating instructions.
- In the event of a fault, disconnect the appliance from the mains: disconnect mains plug (do not pull on the connection cable) or trigger or unscrew fuse.
- Any repairs and work on the appliance should only be carried out by the customer service department, as unauthorised work could prove highly dangerous for the user. The same applies to changing the mains power cable.



### Safety during use

- Do not store explosives or sprays using combustible propellants such as butane, propane, pentane, etc. in the appliance. Electrical components might cause leaking gas to ignite. You can identify such sprays by the printed contents or a flame symbol.
- Only store high-percentage alcohol in tightly sealed, upright containers.
- Do not allow naked flames or ignition sources to enter the appliance.
- Do not use electrical appliances inside the appliance (e.g. steam cleaners, heaters, ice makers, etc.).
- Do not stand on the plinth, drawers or doors or use them to support anything else.
- This appliance is not intended for use by persons (including children) with reduced physical, sensory or mental capabilities or lack of experience and knowledge unless they have been given initial supervision or instruction concerning use of the appliance by a person responsible for their safety. Children should be supervised to ensure that they do not play with the appliance.
- Avoid prolonged skin contact with cold surfaces or chilled/frozen food. This could cause pain, numbness and frostbite. In the case of prolonged skin contact, protective measures should be taken, e.g. gloves should be worn.
- Do not consume food which has been stored for too long, as it could cause food poisoning.
- Special-purpose lamps (incandescent lamps, LEDs, fluorescent tubes) in the appliance serve to illuminate the appliance interior and are not suited for room illumination.



### Setting up

- When setting up/fitting ensure that the refrigerant circuit pipes are not damaged.
- Once in position, use a 10 spanner to adjust the feet so that the appliance is level and does not wobble.
- Standard EN 378 specifies that the room in which you install your appliance must have a volume of 1 m<sup>3</sup> per 8 g of R 600a refrigerant used in the appliance, so as to avoid the formation of inflammable gas/air mixtures in the room where the appliance is located in the event of a leak in the refrigerant circuit. The quantity of refrigerant used in your appliance is indicated on the type plate on the inside of the appliance.
- Always position the appliance directly up against the wall.
- **The ventilation grilles should not be obstructed.** Please note the appendix concerning installation instructions.
- Condensation may form on the outside of the refrigerator/freezer during periods of high humidity. Constant ventilation of the installation site is recommended.
- Do not place heat-emitting appliances, e.g. microwave oven, toaster, etc., on top of the refrigerator or freezer.
- In order to avoid the risk of fire, do not place any burning candles, lamps or other objects with open flames on the refrigerator/freezer.
- Fire hazard due to dampness! If live parts or the mains lead become damp this may cause short circuits.
  - The appliance is designed for use in enclosed areas. Do not operate the appliance outdoors or in areas where it is exposed to splash water or damp conditions.
- CAUTION! Risk of injury and danger of damage as a result of incorrect transport!
  - Transport the appliance in a packed condition.
  - Transport the appliance upright.
  - Do not transport the appliance without assistance.

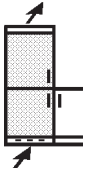

### Connecting to the mains

#### Power supply (AC) and voltage

at the operating point must comply with the details on the rating plate, which is located on the inside left of the appliance, next to the vegetable bins.

- **Connect the appliance with a properly earthed fused plug and socket only.**
- The socket must be fused with a 10 A fuse or higher, it must be away from the rear of the appliance and must be easily accessible.
- Do not connect the appliance to the supply with other equipment using a distribution outlet - risk of overheating.
- When removing the mains cable from the back of the appliance, remove the  **cable holder** as well so as to avoid vibration noise.



The wires in the mains lead are coloured in accordance with the following code:

green/yellow = earth,  
blue = neutral,  
brown = live.

**Warning! This appliance must be earthed.**

#### Non-rewireable plugs BS 1363

If this machine or appliance is fitted with a non-rewireable plug, the following information applies: If the socket outlets are not suitable for the plug supplied with this product, it must be cut off and an appropriate plug fitted. The plug cut from the flexible cord should be disposed of and on no account be inserted into a 13 A socket elsewhere in the house (electric shock hazard). The fuse cover **must** be re-fitted when changing the fuse, and if the fuse cover is lost the plug **must not** be used until a suitable replacement is obtained. The colour of the correct replacement cover is that of the coloured insert in the base of the plug, or the colour that is embossed in words on the base of the plug (as applicable to the design of the plug fitted).

The correct rating of the replacement fuses that are ASTA approved to BS 1362 should be fitted. Replacement fuse covers may be purchased from your local electrical suppliers, electricity showroom or approved service agent.

# 3 Putting into operation and controls

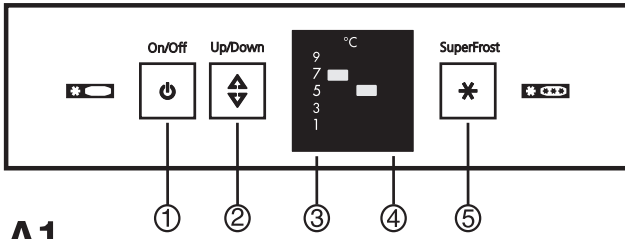

## Temperature display

The following are displayed in normal mode:

- The set fridge temperature ③

The display flashes:

- The temperature setting is being changed
- The temperature has risen by several degrees.

### A1

You are advised to clean the appliance before switching it on for the first time (see "Cleaning").

Put the appliance into operation approximately 4 hours before loading with frozen food for the first time. Only insert frozen food when the freezer compartment is cold.

## Switching the appliance on and off Fig. A1

### Switching on:

To switch on the entire appliance you only need to switch on the fridge section.

When the fridge section is switched on, the freezer section is switched on, too.

- Briefly press the On/Off button ① .  
The temperature displays light up. The fridge and freezer sections are switched on.

### Switching off:

- To switch off the entire appliance you only need to switch off the fridge section. The freezer section is automatically switched off, too.
- Press the On/Off button ① for approx. 2s.
- The temperature displays are dark. The appliance is switched off.
- The interior lighting is dark.

## Adjusting the temperature Fig. A1

### ● Fridge section:

The temperature depends on the following factors:

- The frequency of opening the door
  - The room temperature of the installation location
  - The type, temperature and quantity of the frozen food
- Recommended temperature setting: 5 °C.

The temperature can be changed progressively. When the setting 1 °C is reached, it begins again at 9 °C.

- Press the adjustment button ② until the LED of the desired temperature lights up.

**Note:** Pressing the Up/Down button once activates the nominal value adjustment.

By pressing the adjustment button for a long time, a colder setting is adjusted within a small temperature range (e.g.: between ``5`` and ``7``), but it is not visible on the display.

### ● Freezer section:

The recommended temperature setting of 5°C in the cooling section will produce an average temperature of approx. -18°C in the freezer section.

## 4 Refrigerator compartment

### Arrangement of food

Due to the natural air circulation in the refrigerator compartment, different temperature ranges result, which are beneficial for the storage of different foods. Just above the vegetable bins and at the back of the refrigerator, the air is colder, ideal for raw meat or cold meats; at the top front of the compartment and in the door, the air is warmer, making it ideal for cheese and for spreadable butter.

#### Notes on refrigerating

- Store food so that the air can circulate freely; do not place items too close together. *Do not cover the ventilator air slots\* on the rear wall* - important for refrigerating capacity!
- Always keep foods which easily give off or take on odours or flavours, and liquids, in closed containers or covered.
- Always store food which gives off or is sensitive to ethylene gases such as fruit, vegetables and salads separately or wrapped in order not to affect their storage life; e.g. do not store tomatoes together with kiwis or cabbage.

### Changing the interior lighting

#### Light-bulb specifications:

max. 25 W

Socket: E 14

The current and voltage types should agree with the information on the type plate

- Switch off the appliance. **Remove the mains plug, or trigger or remove the fuse.**
- Hold the lamp cover at the front according to the illustration, and detach at the rear.
- Replace the bulb.
- Re-install the cover.

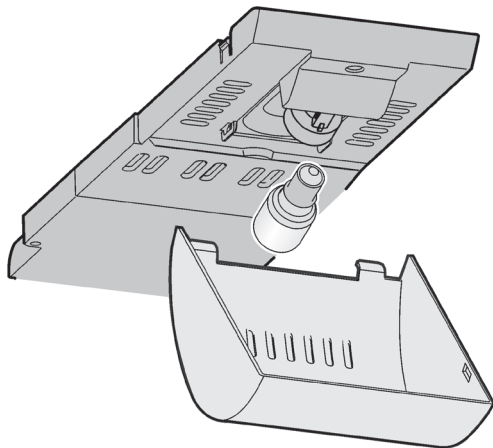

## 5 Freezer compartment

### Making ice-cubes

- Fill the **ice-cube tray\*** three-quarters full with water and freeze. The ice-cubes can be removed from the tray by twisting or by holding upside down for a short time under running water.

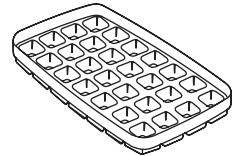

### SuperFrost

The *fresh* foods should be frozen to the core as quickly as possible and frozen foods already stored be given a "cold reserve". This is enabled by the SuperFrost system. This is the best way of maintaining the nutritional value, appearance and flavour of frozen foods.

- The maximum amount of fresh food which can be frozen in 24 hours is shown on the rating plate ("Freezing capacity ... kg/24h"), fig. **A4**, pos. ④. The maximum quantity of frozen food varies according to model and climatic class.

### Freezing with SuperFrost

#### Fig. A1/⑤

You do *not* have to switch SuperFrost on:

- when inserting already frozen foods,
- when freezing up to approx. 2 kg of fresh food daily.
- Press SuperFrost button ⑤ briefly, so that the LED lights up.
- The freezing temperature decreases, the appliance works with the greatest possible freezing capacity.
- With a smaller amount of food to be frozen, wait/pre-freeze for approx 6 hours - normally sufficient, with the *maximum* quantity, see freezing capacity on rating plate, approx. 24 hours.
- Then insert the fresh food.
- The SuperFrost function can be quit manually by briefly pressing button ⑤, if not:
- SuperFrost switches off **automatically** after approximately 65 hours.
- the SuperFrost button is dark
- the temperature range set for normal mode lights up in the temperature display.
- the appliance continues in normal energy-saving mode.
- In order to reach the maximum freezer performance, warm food must be placed directly on the shelves, not in the drawers, or stored in direct contact to the inner side walls.



## 5 Freezer compartment

### Notes on freezing and storage

- As a guideline for the storage time, the following applies to various foodstuffs in the freezer compartment:

Ice cream	2 to 6 months
Sausage, ham	2 to 6 months
Bread, cakes and pastries	2 to 6 months
Game, pork	6 to 10 months
Fish, oily	2 to 6 months
Fish, lean	6 to 12 months
Cheese	2 to 6 months
Poultry, beef	6 to 12 months
Vegetables, fruit	6 to 12 months

- **Suitable packing materials** are conventional freezer bags, reusable plastic, metal and aluminium containers.
- Do not allow fresh food to be frozen to come into contact with food already frozen. Always insert packaging in a dry condition to avoid packaging freezing together.
- Always provide packaging with date and contents and do not exceed the recommended storage time of the frozen food, in order to prevent reductions in quality.
- Always package food which you freeze yourself in suitable portions for your household. So that the food freezes quickly through to the core, the following quantities per package should not be exceeded:
  - Fruit and vegetables up to 1 kg,
  - meat up to 2.5 kg.
- After washing and portioning, blanch **vegetables** (immerse in boiling water for 2-3 minutes, then remove and cool in cold water). If blanching with a steamer or microwave, observe the relevant instructions).
- Do not salt or season food and blanched vegetables before freezing. Only lightly salt and season other foods. The intensity of flavour of certain seasonings changes.
- Do not freeze bottles and tins containing carbonated beverages, as otherwise they may burst.
- **For storage:** The individual storage tray can support max. 25 kg of frozen goods.
- **VarioSpace\***: By removing the 2nd and 3rd drawer and the storage tray, you obtain the storage space for bulky goods equivalent to two drawer heights. Poultry, meat, large game pieces and tall baked goods can be frozen whole and further prepared in one piece.
- If you wish to use the max. holding capacity, you can remove the drawers and store the frozen goods directly on the storage trays .
  - **Removing drawers**, fig. G1: pull out to stop position and lift up at front.
  - **Removing storage tray**, fig. G2: remove 2nd and 3rd drawer, lift storage tray up at front and pull out.  
To insert: simply push storage tray in, snap into position at front.

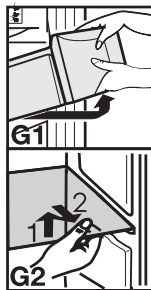

- **For defrosting**, always only remove as much as will be needed immediately. Defrosted food should be used to prepare a meal as soon as possible.  
You can defrost frozen food:
  - in the oven/fan-assisted oven
  - in the microwave
  - at room temperature
  - Defrosted flat meat and fish portions can be heated up.
  - Vegetables can be prepared in a frozen state (at half cooking time as fresh vegetables).

## 6 Defrosting

### Defrosting

#### The refrigerator compartment

defrosts automatically. The defrost water is evaporated by the heat from the compressor; drops of water on the rear wall are perfectly normal.

- Ensure that the defrost water can flow freely through the drain hole in the rear wall (arrow in fig. A).

#### The freezer compartment

- To defrost, switch off the appliance:
  - Disconnect the appliance from the mains .
- If possible, put the frozen goods in the freezer drawer, wrap in newspaper or a blanket and store in a cool place.
- To speed up the defrosting process place a saucepan of hot but not boiling water on one of the middle shelves.  
**Do not use electric heaters or steam cleaners, defrosting sprays or naked flames for defrosting nor any metal objects for removing the ice. Risk of injury and damage!**
- Leave the appliance door open when defrosting. After defrosting, mop up the remaining water with a sponge or cloth and clean the appliance.



# 8 Instructions for installation and modification

Before reading, please fold out and refer to the illustrated back page.



GB

The **external dimensions** of the appliance can be seen on fig. **S**.

Do not install the appliance side-by-side with another refrigerator or freezer. This is important to prevent condensation and consequential damage from it.

## Changing over door hinges

You can change over the door hinges if necessary:

Make sure that the following tools are at hand:

- Torx 25
- Torx 15
- Screwdriver
- Cordless screwdriver, if required

### Screw off the upper bearing block

- Close the upper door.
- Remove cover Fig. 1 (1) and cover Fig. 1 (2).
- Screw off the upper bearing block Fig. 1 (3) (2 mal Torx 25) Fig. 1 (4) and lift upwards.

### CAREFUL!

Danger of injury when the door tilts outwards!

- Hold the door well.
- Carefully set down the door.

### Removing the upper door

- Lift off the upper door upwards and set aside.
- Lift the plug Fig. 4 (30) out of the upper door bearing bush and set down.

### Removing the lower door

- Close the lower door.
- Pull off the plastic cap Fig. 2 (10).
- Pull out the centre bearing bolt Fig. 2 (11).
- Remove the door upwards and set aside.
- Lift the plug Fig. 4 (30) out of the lower door bearing bush and re-locate.

### Re-locate the centre bearing components

- Pull off the cover panel Fig. 2 (12).
- Screw off the centre bearing block Fig. 2 (13) and relocate to the new hinge side by turning by 180°.
- Engage the cover panel Fig. 2 (12) on the new handle side.

### Re-locate the lower bearing components

- Remove the lower cover Fig. 3 (21) forwards.
- Remove the lower cover Fig. 3 (22) downwards and forwards.

In doing so, pay attention to the hinge bush Fig. 3 (20).

- Screw off the bearing block Fig. 3 (23) (3 x Torx 25) Fig. 3 (24).
- Screw off the bearing component Fig. 3 (26) (1 x Torx 25) Fig. 3 (27) and re-locate it into the opposite mounting hole, then firmly screw in again.
- Lift off and re-locate the cover on the handle side Fig. 3 (25).
- Screw the bearing block Fig. 3 (23) back onto the new hinge side.

### Fit the lower door

- Place the door onto the bottom bearing bolt from the top Fig. 3 (22).
- Close the door.
- Install the centre bearing bolt Fig. 2 (11) on the new hinge side into the lower door through the centre bearing block Fig. 2 (13).
- Place the plastic cap Fig. 2 (10) turned by 180° back onto the centre bearing block Fig. 2 (13).

### Fit the upper door

- Place the upper door onto the centre bearing bolt Fig. 2 (11).
- Install the upper bearing block Fig. 1 (3) on the new hinge side and in the door.
- Screw the upper bearing block Fig. 1 (2 x Torx 25) Fig. 1 (4) in tightly.
- Engage cover Fig. 1 (1) and cover Fig. 1 (2) respectively on the opposite side.

### Re-locate the handles

- Disengage the spring clamp Fig. 4 (31) from the fridge section door and re-locate on the new hinge side.
- Dismantle the door handles Fig. 4 (32), plugs Fig. 4 (33) and pressure plates Dismantle Fig. 4 (34) with the door open.
- Ensure proper engagement when fitting the pressure plates.
- Align the doors flush with the appliance housing possibly via the two slotted holes in the lower bearing block Fig. 3 (23) and the centre bearing block Fig. 2 (13), then firmly tighten the screws.
- Engage the cover Fig. 3 (21) again.

## Insertion into row of kitchen units

- ① top unit
- ② refrigerator/freezer
- ③ Kitchen cupboard
- ④ wall

Fig. **U**: The appliances can be installed in a row of kitchen units. To adapt the height of the appliance to the surrounding furniture a top unit ① can be added.

When retrofitting with standard kitchen cabinets (max. depth 580 mm), the appliance can be set up directly next to the kitchen cupboard Fig. **U** ③. The appliance door protrudes 34 mm at the side and 50 mm in the middle of the appliance against the front panel of the kitchen cupboard. It can therefore be opened and closed without any problems.

Important for ventilation:

- On the rear side of the top unit there must be a ventilation duct of at least 50 mm depth along the entire width of the top unit.
- The area of ventilation underneath the ceiling must be at least 300 cm<sup>2</sup>.
- The larger the ventilation cross section, the more energy the appliance will be able to save.

If the appliance is installed with the hinge side against a wall Fig. **U** ④, the distance between the appliance and the wall must be at least 36 mm. This corresponds with the handle protrusion when the door is open.

All types and models are subject to continuous improvement and the manufacturer therefore reserves the right to make modifications in the shape, equipment and technology.

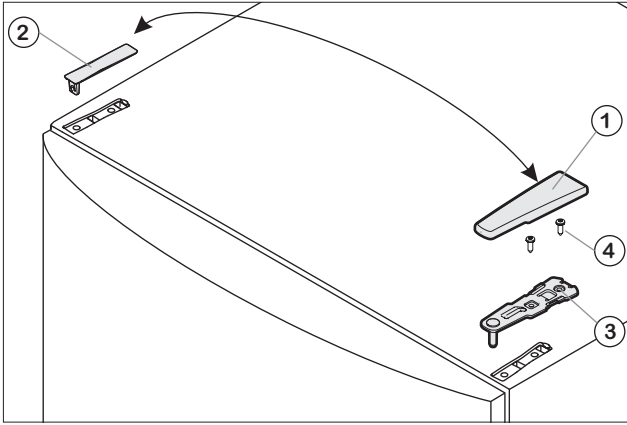

Fig. 1

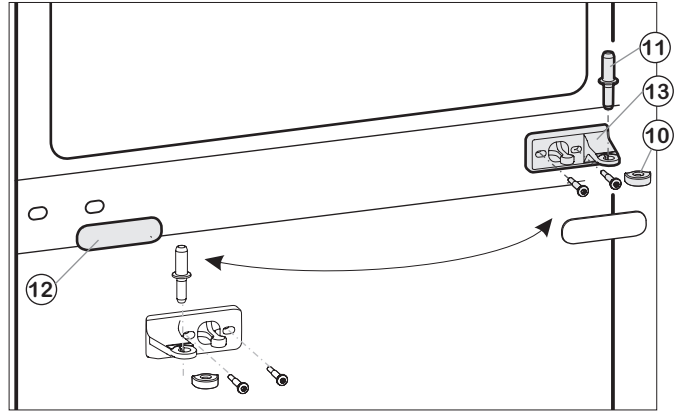

Fig. 2

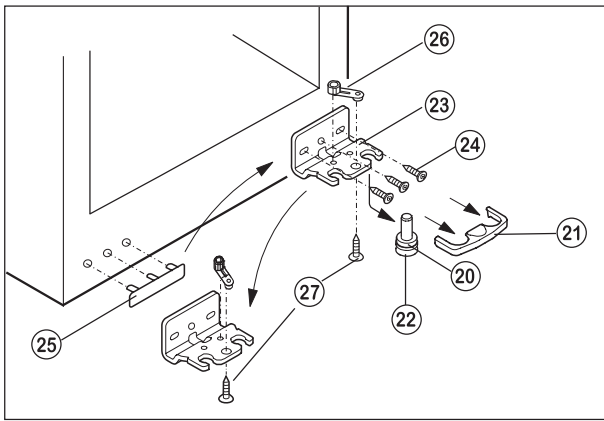

Fig. 3

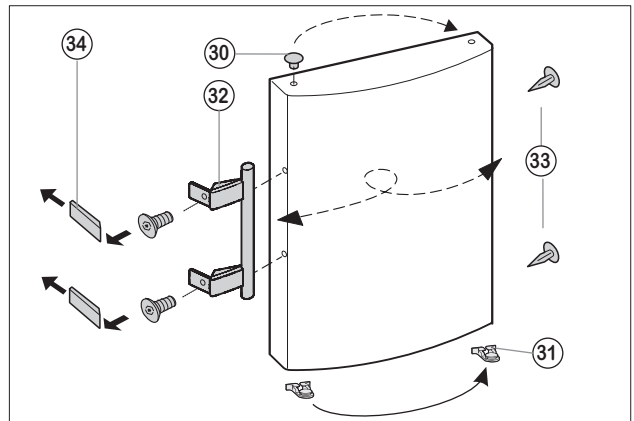

Fig. 4

